

### Hydrauliek adapters

De adapter vormt het verbindingsstuk tussen het aan te sluiten component en de hydraulische leiding.

Adapters maken het mogelijk een verantwoorde overgang te maken tussen verschillende aansluitvormen en draadsoorten. Daarnaast kan een adapter verschillen in leidingdoorlaat binnen een systeem overbruggen.

"Knie" adapters kunnen nuttig zijn bij het inbouwen van slangen in kleine ruimtes of om extreme buigingen in slangen te voorkomen. (Zie montage slangassemblages in het hoofdstuk slangassemblages)

Met "T"-adapters en "kruis" adapters kunnen leidingen gesplitst of samengevoegd worden.

Een adapter is altijd een schakel in het hydrauliek systeem. Daarom moet bij de selectie altijd nagegaan worden of de drukbestendigheid en doorlaat voldoende zijn.

Daar in het Fluiconnecto adapterprogramma een veelheid van maten, draadsoorten en afdichtingsvormen gecombineerd worden, is het onmogelijk een algemeen geldend overzicht van werkdrukken van adapters te geven. De verkoopafdeling van Fluiconnecto kan u hierover advies geven.

Fluiconnecto heeft een uitgebreid programma roestvrijstalen adapters.

#### Dubbelnippel BSP/BSP

bestelnr.	uitw. BSP	uitw. BSP
2244-02-02	1/8-28	1/8-28
2244-02-04	1/8-28	1/4-19
2244-04-04	1/4-19	1/4-19
2244-04-06	1/4-19	3/8-19
2244-04-08	1/4-19	1/2-14
2244-06-06	3/8-19	3/8-19
2244-06-08	3/8-19	1/2-14
2244-06-12	3/8-19	3/4-14
2244-08-08	1/2-14	1/2-14
2244-08-10	1/2-14	5/8-14
2244-08-12	1/2-14	3/4-14
2244-08-16	1/2-14	1-11
2244-10-10	5/8-14	5/8-14
2244-10-12	5/8-14	3/4-14
2244-12-12	3/4-14	3/4-14
2244-12-16	3/4-14	1-11
2244-16-16	1-11	1-11
2244-16-20	1-11	1 1/4-11
2244-16-24	1-11	1 1/2-11
2244-20-20	1 1/4-11	1 1/4-11
2244-20-24	1 1/4-11	1 1/2-11
2244-24-24	1 1/2-11	1 1/2-11
2244-24-32	1 1/2-11	2-11
2244-32-32	2-11	2-11

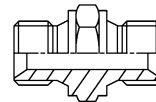

**Kniestuk BSP/BSP**

bestelnr.	uitw. BSP	uitw. BSP
2644-04-04	1/4-19	1/4-19
2644-04-06	1-4-19	3/8-19
2644-06-06	3/8-19	3/8-19
2644-06-08	3/8-19	1/2-14
2644-08-08	1/2-14	1/2-14
2644-08-12	1/2-14	3/4-14
2644-10-10	5/8-14	5/8-14
2644-12-12	3/4-14	3/4-14
2644-12-16	3/4-14	1-11
2644-16-16	1-11	1-11

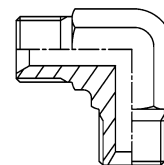
**T-stuk BSP/BSP**

bestelnr.	uitw. BSP	uitw. BSP	uitw. BSP
2744-04-04	1/4-19	1/4-19	1/4-19
2744-06-06	3/8-19	3/8-19	3/8-19
2744-08-08	1/4-14	1/4-14	1/4-14
2744-10-10	5/8-14	5/8-14	5/8-14
2744-12-12	3/4-14	3/4-14	3/4-14
2744-16-16	1-11	1-11	1-11

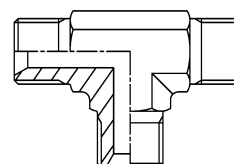
**Kniestuk 90° instelbaar BSP/BSP**

bestelnr.	uitw. BSP	uitw. BSP
2648-02-02	1/8	1/8
2648-04-04	1/4	1/4
2648-06-06	3/8	3/8
2648-08-08	1/2	1/2
2648-12-12	3/4	3/4
2648-16-16	1	1
2648-20-20	1 1/4	1 1/4
2648-24-24	1 1/2	1 1/2

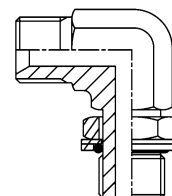
**Schotverbinding BSP/BSP**

bestelnr.	uitw. BSP	uitw. BSP
8248-02-02	1/8	1/8
8248-04-04	1/4	1/4
8248-06-06	3/8	3/8
8248-08-08	1/2	1/2
8248-10-10	5/8	5/8
8248-12-12	3/4	3/4
8248-16-16	1	1
8248-20-20	1 1/4	1 1/4
8248-24-24	1 1/2	1 1/2

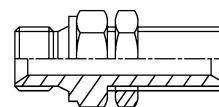

### Plug BSP

bestelnr.	uitw. BSP
2140-02	1/8-28
2140-04	1/4-19
2140-06	3/8-19
2140-08	1/2-14
2140-10	5/8-14
2140-12	3/4-14
2140-16	1-11
2140-20	1 1/4-11
2140-24	1 1/2-11
2140-32	2-11

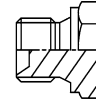

### Blindkap BSP

bestelnr.	inw. BSP
2113-02	1/8-28
2113-04	1/4-19
2113-06	3/8-19
2113-08	1/2-14
2113-10	5/8-14
2113-12	3/4-14
2113-16	1-11
2113-20	1 1/4-11
2113-24	1 1/2-11
2113-32	2-11

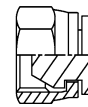

**Verlooping BSP/BSP**

Tevens leverbaar met ED afdichting.

bestelnr.	uitw. BSP	inw. BSP	type
RI1/8x3/8	1/8-28	3/8-19	II
RI1/8x1/4	1/8-28	1/4-19	II
RI1/4x3/4	1/4-19	3/4-14	II
RI1/4x1/2	1/4-19	1/2-14	II
RI1/4x3/8	1/4-19	3/8-19	II
RI1/4x1/8	1/4-19	1/8-28	II
RI3/8x3/4	3/8-19	3/4-14	II
RI3/8x1/2	3/8-19	1/2-14	II
RI3/8x1/4	3/8-19	1/4-19	II
RI3/8x1/8	3/8-19	1/8-28	I
RI1/2x11/4	1/2-14	1 1/4-11	II
RI1/2x1	1/2-14	1-11	II
RI1/2x3/4	1/2-14	3/4-14	II
RI1/2x3/8	1/2-14	3/8-19	II
RI1/2x1/4	1/2-14	1/4-19	I
RI1/2x1/8	1/2-14	1/8-28	I
RI3/8x11/2	3/4-14	1 1/2-11	II
RI3/4x11/4	3/4-14	1 1/4-11	II
RI3/4x1	3/4-14	1-11	II
RI3/4x1/2	3/4-14	1/2-14	II
RI3/4x3/8	3/4-14	3/8-19	I
RI3/4x1/4	3/4-14	1/4-19	I
RI1x11/2	1-11	1 1/2-11	II
RI1x11/4	1-11	1 1/4-11	II
RI1x3/4	1-11	3/4-14	II
RI1x1/2	1-11	1/2-14	I
RI1x3/8	1-11	3/8-19	I
RI1x1/4	1-11	1/4-19	I
RI11/4x11/2	1 1/4-11	1 1/2-11	II
RI11/4x1	1 1/4-11	1-11	II
RI11/4x3/4	1 1/4-11	3/4-14	I
RI11/4x1/2	1 1/4-11	1/2-14	I
RI11/2x11/4	1 1/2-11	1 1/4-11	II
RI11/2x1	1 1/2-11	1-11	I
RI11/2x3/4	1 1/2-11	3/4-14	I
RI11/2x1/2	1 1/2-11	1/2-14	I
RI2x3/4	2-11	3/4-14	I
RI2x1	2-11	1-11	I
RI2x11/4	2-11	1 1/4-11	I
RI2x11/2	2-11	1 1/2-11	I

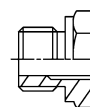

Type I

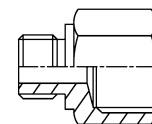

Type II

## Sok BSP/BSP

bestelnr.	inw. BSP	inw. BSP
8244-02-02	1/8-28	1/8-28
8244-02-04	1/8-28	1/4-19
8244-04-04	1/4-19	1/4-19
8244-04-06	1/4-19	3/8-19
8244-06-06	3/8-19	3/8-19
8244-04-08	1/4-19	1/2-14
8244-06-08	3/8-19	1/2-14
8244-08-08	1/2-14	1/2-14
8244-08-10	1/2-14	5/8-14
8244-08-12	1/2-14	3/4-14
8244-08-16	1/2-14	1-11
8244-10-10	5/8-14	5/8-14
8244-10-12	5/8-14	3/4-14
8244-12-06	3/4-14	3/8-19
8244-12-12	3/4-14	3/4-14
8244-12-16	3/4-14	1-11
8244-16-16	1-11	1-11
8244-16-20	1-11	1 1/4-11
8244-20-20	1 1/4-11	1 1/4-11
8244-20-24	1 1/4-11	1 1/2-11
8244-24-24	1 1/2-11	1 1/2-11
8244-24-32	1 1/2-11	2-11
8244-32-32	2-11	2-11

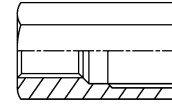

## Lassok zwaar BSP/BSP

bestelnr.	inw. BSP	inw. BSP	øD [mm]	L [mm]
8284-04-04	1/4-19	1/4-19	22	37
8284-06-06	3/8-19	3/8-19	22	38
8284-08-08	1/2-14	1/2-14	29	48
8284-12-12	3/4-14	3/4-14	35	51
8284-16-16	1-11	1-11	45	60
8284-20-20	1 1/4-11	1 1/4-11	60	67
8284-24-24	1 1/2-11	1 1/2-11	65	79
8284-32-32	2-11	2-11	76	90

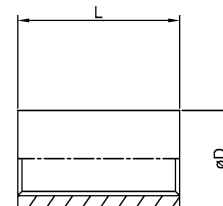

## Verbindingsnippel BSP/BSP

bestelnr.	wartel BSP	wartel BSP
2213-02-02	1/8-28	1/8-28
2213-02-04	1/8-28	1/4-19
2213-04-04	1/4-19	1/4-19
2213-04-06	1/4-19	3/8-19
2213-04-08	1/4-19	1/2-14
2213-06-06	3/8-19	3/8-19
2213-06-08	3/8-19	1/2-14
2213-06-12	3/8-19	3/4-14
2213-08-08	1/2-14	1/2-14
2213-08-12	1/2-14	3/4-14
2213-08-16	1/2-14	1-11
2213-10-12	5/8-14	3/4-14
2213-08-10	1/2-14	5/8-14
2213-12-12	3/4-14	3/4-14
2213-12-16	3/4-14	1-11
2213-16-16	1-11	1-11
2213-16-20	1-11	1 1/4-11
2213-20-20	1 1/4-11	1 1/4-11

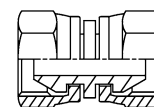

## Bochtstuk 45° BSP/BSP

bestelnr.	wartel BSP	wartel BSP
2813-04-04	1/4-19	1/4-19
2813-06-06	3/8-19	3/8-19
2813-08-08	1/2-14	1/2-14
2813-12-12	3/4-14	3/4-14
2813-16-16	1-11	1-11
2813-20-20	1 1/4-11	1 1/4-11

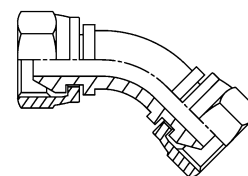

## Bochtstuk 90° BSP/BSP

bestelnr.	wartel BSP	wartel BSP
2913-04-04	1/4-19	1/4-19
2913-06-06	3/8-19	3/8-19
2913-08-08	1/2-14	1/2-14
2913-12-12	3/4-14	3/4-14
2913-16-16	1-11	1-11
2913-20-20	1 1/4-11	1 1/4-11

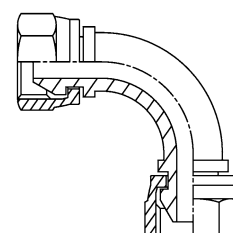

### Verbindingsnippeel BSP/BSP

bestelnr.	uitw. BSP	wartel BSP
2243-02-02	1/8-28	1/8-28
2243-02-04	1/8-28	1/4-19
2243-04-04	1/4-19	1/4-19
2243-04-02	1/4-19	1/8-28
2243-04-06	1/4-19	3/8-19
2243-04-08	1/4-19	1/2-14
2243-06-06	3/8-19	3/8-19
2243-06-02	3/8-19	1/8-28
2243-06-04	3/8-19	1/4-19
2243-06-08	3/8-19	1/2-14
2243-08-08	1/2-14	1/2-14
2243-08-04	1/2-14	1/4-19
2243-08-06	1/2-14	3/8-19
2243-08-10	1/2-14	5/8-14
2243-08-12	1/2-14	3/4-14
2243-08-16	1/2-14	1-11
2243-10-10	5/8-14	5/8-14
2243-10-06	5/8-14	3/8-19
2243-10-08	5/8-14	1/2-14
2243-10-12	5/8-14	3/4-14
2243-12-12	3/4-14	3/4-14
2243-12-08	3/4-14	1/2-14
2243-12-10	3/4-14	5/8-14
2243-12-16	3/4-14	1-11
2243-12-20	3/4-14	1 1/4-11
2243-16-16	1-11	1-11
2243-16-08	1-11	1/2-14
2243-16-10	1-11	5/8-14
2243-16-12	1-11	3/4-14
2243-16-20	1-11	1 1/4-11
2243-20-20	1 1/4-11	1 1/4-11
2243-20-12	1 1/4-11	3/4-14
2243-20-16	1 1/4-11	1-11
2243-20-24	1 1/4-11	1 1/2-11
2243-24-24	1 1/2-11	1 1/2-11

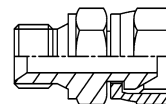

### Adapter BSP/BSP

bestelnr.	uitw. BSP	inw. BSP
2242-02-02	1/8-28	1/8-28
2242-04-04	1/4-19	1/4-19
2242-06-06	3/8-19	3/8-19
2242-08-08	1/2-14	1/2-14
2242-12-12	3/4-14	3/4-14
2242-16-16	1-11	1-11

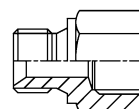

**Kniestuk 90° BSP/BSP**

bestelnr.	uitw. BSP	wartel BSP
2643-04-04	1/4-19	1/4-19
2643-04-06	1/4-19	3/8-19
2643-06-06	3/8-19	3/8-19
2643-06-04	3/8-19	1/4-19
2643-08-06	1/2-14	3/8-19
2643-08-08	1/2-14	1/2-14
2643-10-08	5/8-14	1/2-14
2643-10-10	5/8-14	5/8-14
2643-12-08	3/4-14	1/2-14
2643-12-12	3/4-14	3/4-14
2643-16-12	1-11	3/4-14
2643-16-16	1-11	1-11

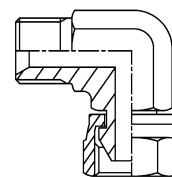
**Bochtstuk 45° BSP/BSP**

bestelnr.	uitw. BSP	wartel BSP
2843-04-04	1/4-19	1/4-19
2843-06-06	3/8-19	3/8-19
2843-08-08	1/2-14	1/2-14
2843-12-12	3/4-14	3/4-14
2843-16-16	1-11	1-11
2843-20-20	1 1/4-11	1 1/4-11

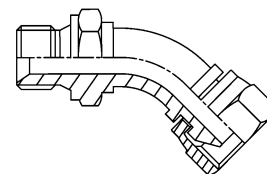
**Bochtstuk 90° BSP/BSP**

bestelnr.	uitw. BSP	inw. BSP
2943-04-04	1/4-19	1/4-19
2943-06-06	3/8-19	3/8-19
2943-08-08	1/2-14	1/2-14
2943-12-12	3/4-14	3/4-14
2943-16-16	1-11	1-11
2943-20-20	1 1/4-11	1 1/4-11
2943-24-24	1 1/2-11	1 1/2-11
2943-32-32	2-11	2-11

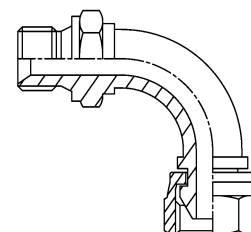
**T-stuk BSP/BSP**

bestelnr.	wartel BSP	wartel BSP	wartel BSP
2713-04-04	1/4-19	1/4-19	1/4-19
2713-06-06	3/8-19	3/8-19	3/8-19
2713-08-08	1/2-14	1/2-14	1/2-14
2713-10-10	5/8-14	5/8-14	5/8-14
2713-12-12	3/4-14	3/4-14	3/4-14
2713-16-16	1-11	1-11	1-11

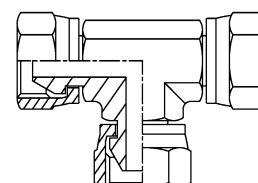



## T-stuk BSP/BSP

bestelnr.	uitw. BSP	wartel BSP	uitw. BSP
2714-04-04	1/4-19	1/4-19	1/4-19
2714-06-06	3/8-19	3/8-19	3/8-19
2714-08-08	1/2-14	1/2-14	1/2-14
2714-10-10	5/8-14	5/8-14	5/8-14
2714-12-12	3/4-14	3/4-14	3/4-14
2714-16-16	1-11	1-11	1-11

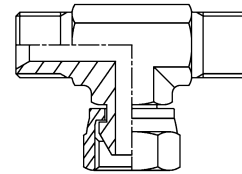

## T-stuk BSP/BSP

bestelnr.	uitw. BSP	uitw. BSP	wartel BSP
2715-04-04	1/4-19	1/4-19	1/4-19
2715-06-06	3/8-19	3/8-19	3/8-19
2715-08-08	1/2-14	1/2-14	1/2-14
2715-10-10	5/8-14	5/8-14	5/8-14
2715-12-12	3/4-14	3/4-14	3/4-14
2715-16-16	1-11	1-11	1-11

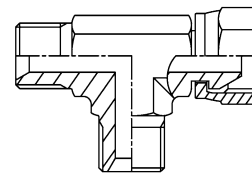

## Kniestuk 90° BSP/BSPT

bestelnr.	uitw. BSPT	inw. BSP
8643-02-02	1/8-28	1/8-28
8643-04-04	1/4-19	1/4-19
8643-06-06	3/8-19	3/8-19
8643-08-08	1/2-14	1/2-14
8643-12-12	3/4-14	3/4-14
8643-16-16	1-11	1-11

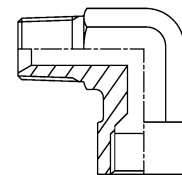

## Kniestuk 45° BSP/BSP

bestelnr.	inw. BSP	inw. BSP
8444-02-02	1/8-28	1/8
8444-04-04	1/4-19	1/4
8444-06-06	3/8-19	3/8
8444-08-08	1/2-14	1/2
8444-12-12	3/4-14	3/4

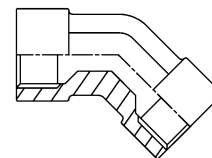

**Kniestuk 90° BSP/BSP**

bestelnr.	inw. BSP	inw. BSP
8644-02-02	1/8-28	1/8
8644-04-04	1/4-19	1/4
8644-06-06	3/8-19	3/8
8644-08-08	1/2-14	1/2
8644-12-12	3/4-14	3/4
8644-16-16	1-11	1
8644-20-20	1 1/4-11	1 1/4

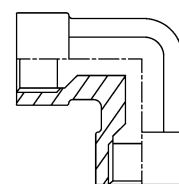
**T-stuk BSP/BSP**

bestelnr.	inw. BSP	inw. BSP	inw. BSP
8744-02-02	1/8-28	1/8-28	1/8-28
8744-04-04	1/4-19	1/4-19	1/4-19
8744-06-06	3/8-19	3/8-19	3/8-19
8744-08-08	1/2-14	1/2-14	1/2-14
8744-12-12	3/4-14	3/4-14	3/4-14
8744-16-16	1-11	1-11	1-11
8744-20-20	1 1/4-11	1 1/4-11	1 1/4-11

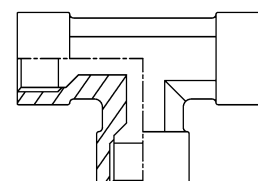
**T-stuk BSP/BSPT**

bestelnr.	inw. BSP	uitw. BSP	inw. BSPT
8745-02-02	1/8-28	1/8-28	1/8-28
8745-04-04	1/4-19	1/4-19	1/4-19
8745-06-06	3/8-19	3/8-19	3/8-19
8745-08-08	1/2-14	1/2-14	1/2-14
8745-12-12	3/4-14	3/4-14	3/4-14
8745-16-16	1-11	1-11	1-11

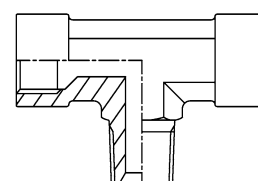
**T-stuk BSP/BSPT**

bestelnr.	inw. BSP	inw. BSP	uitw. BSPT
8746-02-02	1/8-28	1/8-28	1/8-28
8746-04-04	1/4-19	1/4-19	1/4-19
8746-06-06	3/8-19	3/8-19	3/8-19
8746-08-08	1/2-14	1/2-14	1/2-14
8746-12-12	3/4-14	3/4-14	3/4-14
8746-16-16	1-11	1-11	1-11

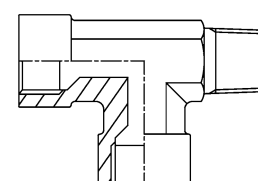

## Adapter BSP/NPTF

bestelnr.	uitw. BSP	uitw. NPTF
2245-02-02	1/8-28	1/8-27
2245-04-04	1/4-19	1/4-18
2245-06-06	3/8-19	3/8-18
2245-08-08	1/2-14	1/2-14
2245-12-12	3/4-14	3/4-14
2245-16-16	1-11	1-11,5
2245-20-20	1 1/4-11	1 1/4-11,5
2245-24-24	1 1/2-11	1 1/2-11,5
2245-32-32	2-11	2-11,5
2245-02-04	1/8-28	1/4-18
2245-02-06	1/8-28	3/8-18
2245-02-08	1/8-28	1/2-14
2245-04-02	1/4-19	1/8-27
2245-04-06	1/4-19	3/8-18
2245-04-08	1/4-19	1/2-14
2245-06-02	3/8-19	1/8-27
2245-06-04	3/8-19	1/4-18
2245-06-08	3/8-19	1/2-14
2245-06-12	3/8-19	3/4-14
2245-08-02	1/2-14	1/8-27
2245-08-04	1/2-14	1/4-18
2245-08-06	1/2-14	3/8-18
2245-08-12	1/2-14	3/4-14
2245-08-16	1/2-14	1-11,5
2245-12-04	3/4-14	1/4-18
2245-12-06	3/4-14	3/8-18
2245-12-08	3/4-14	1/2-14
2245-12-16	3/4-14	1-11,5
2245-12-20	3/4-14	1 1/4-11,5
2245-16-06	1-11	3/8-18
2245-16-08	1-11	1/2-14
2245-16-12	1-11	3/4-14
2245-16-20	1-11	1 1/4-11,5
2245-16-24	1-11	1 1/2-11,5
2245-16-32	1-11	2-11,5
2245-20-12	1 1/4-11	3/4-14
2245-20-16	1 1/4-11	1-11,5
2245-20-24	1 1/4-11	1 1/2-11,5
2245-20-32	1 1/4-11	2-11,5
2245-24-16	1 1/2-11	1-11,5
2245-24-20	1 1/2-11	1 1/4-11,5
2245-24-32	1 1/2-11	2-11,5
2245-32-16	2-11	1-11,5
2245-32-20	2-11	1 1/4-11,5
2245-32-24	2-11	1 1/2-11,5

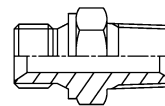

3

## Adapter NPTF/NPTF

bestelnr.	uitw. NPTF	uitw. NPTF
8255-02-02	1/8-27	1/8-27
8255-02-04	1/8-27	1/4-18
8255-02-06	1/8-27	3/8-18
8255-04-04	1/4-18	1/4-18
8255-04-06	1/4-18	3/8-18
8255-04-08	1/4-18	1/2-14
8255-06-06	3/8-18	3/8-18
8255-06-08	3/8-18	1/2-14
8255-08-08	1/2-14	1/2-14
8255-08-12	1/2-14	3/4-14
8255-12-12	3/4-14	3/4-14
8255-12-16	3/4-14	1-11,5
8255-16-16	1-11,5	1-11,5
8255-16-20	1-11,5	1 1/4-11,5
8255-20-20	1 1/4-11,5	1 1/4-11,5
8255-24-24	1 1/2-11,5	1 1/2-11,5
8255-24-32	1 1/2-11,5	2-11,5
8255-32-32	2-11,5	2-11,5

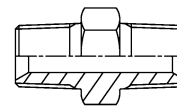

## Adapter NPTF/NPTF

bestelnr.	uitw. NPTF	inw. NPTF	type
8257-02-04	1/8-27	1/4-18	II
8257-02-08	1/8-27	1/2-14	II
8257-04-02	1/4-18	1/8-27	I
8257-04-06	1/4-18	3/8-18	II
8257-04-08	1/4-18	1/2-14	II
8257-04-12	1/4-18	3/4-14	II
8257-06-02	3/8-18	1/8-27	I
8257-06-04	3/8-18	1/4-18	II
8257-06-08	3/8-18	1/2-14	II
8257-08-02	1/2-14	1/8-27	I
8257-08-04	1/2-14	1/4-18	I
8257-08-06	1/2-14	3/8-18	II
8257-08-12	1/2-14	3/4-14	II
8257-08-16	1/2-14	1-11,5	II
8257-12-04	3/4-14	1/4-18	I
8257-12-06	3/4-14	3/8-18	I
8257-12-08	3/4-14	1/2-14	II
8257-12-16	3/4-14	1-11,5	II
8257-16-04	1-11,5	1/4-18	I
8257-16-06	1-11,5	3/8-18	I
8257-16-08	1-11,5	1/2-14	I
8257-16-12	1-11,5	3/4-14	II
8257-16-20	1-11,5	1 1/4-11,5	II
8257-20-12	1 1/4-11,5	3/4-14	I
8257-20-16	1 1/4-11,5	1-11,5	II
8257-20-24	1 1/4-11,5	1 1/2-11,5	II
8257-24-16	1 1/2-11,5	1-11,5	I
8257-24-20	1 1/2-11,5	1 1/4-11,5	II
8257-24-32	1 1/2-11,5	2-11,5	II
8257-32-16	2-11,5	1-11,5	I
8257-32-20	2-11,5	1 1/4-11,5	I
8257-32-24	2-11,5	1 1/2-11,5	I
8257-48-32	3-8	2-11,5	I

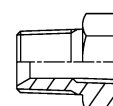

Type I

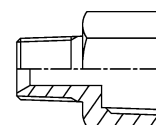

Type II

## Adapters

### Plug NPTF

bestelnr.	uitw. NPTF
8150-02	1/8-27
8150-04	1/4-18
8150-06	3/8-18
8150-08	1/2-14
8150-12	3/4-14
8150-16	1-11,5
8150-20	1 1/4-11,5
8150-24	1 1/2-11,5
8150-32	2-11,5

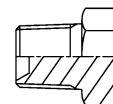

### Kap NPTF

bestelnr.	inw. NPTF
8170-02	1/8-27
8170-04	1/4-18
8170-06	3/8-18
8170-08	1/2-14
8170-12	3/4-14
8170-16	1-11,5
8170-20	1 1/4-11,5
8170-24	1 1/2-11,5
8170-32	2-11,5

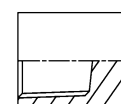

### Sok NPTF/NPTF

bestelnr.	inw. NPTF	inw. NPTF
8277-02-02	1/8-27	1/8-27
8277-02-04	1/8-27	1/4-18
8277-02-06	1/8-27	3/8-18
8277-04-04	1/4-18	1/4-18
8277-04-06	1/4-18	3/8-18
8277-04-08	1/4-18	1/2-14
8277-06-06	3/8-18	3/8-18
8277-06-08	3/8-18	1/2-14
8277-08-08	1/2-14	1/2-14
8277-08-12	1/2-14	3/4-14
8277-12-12	3/4-14	3/4-14
8277-16-16	1-11,5	1-11,5
8277-20-20	1 1/4-11,5	1 1/4-11,5
8277-24-24	1 1/2-11,5	1 1/2-11,5
8277-32-32	2-11,5	2-11,5

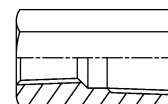

### Kniestuk 90° NPTF

bestelnr.	uitw. NPTF
8655-02-02	1/8-27
8655-04-04	1/4-18
8655-06-06	3/8-18
8655-08-08	1/2-14
8655-12-12	3/4-14
8655-16-16	1-11,5
8655-20-20	1 1/4-11,5

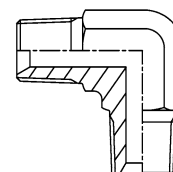

**Kniestuk 90° NPTF**

bestelnr.	inw. NPTF	inw. [mm]
8677-02-02	1/8-27	1/8-27
8677-04-04	1/4-18	1/4-18
8677-06-06	3/8-18	3/8-18
8677-08-08	1/2-14	1/2-14
8677-12-12	3/4-14	3/4-14
8677-16-16	1-11,5	1-11,5
8677-20-20	1 1/4-11,5	1 1/4-11,5
8677-24-24	1 1/2-11,5	1 1/2-11,5

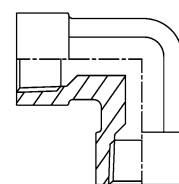
**Kniestuk 45° NPTF/NPTF**

bestelnr.	uitw. NPTF	inw. NPTF
8457-02-02	1/8-27	1/8-27
8457-04-04	1/4-18	1/4-18
8457-06-06	3/8-18	3/8-18
8457-08-08	1/2-14	1/2-14
8457-12-12	3/4-14	3/4-14
8457-16-16	1-11,5	1-11,5

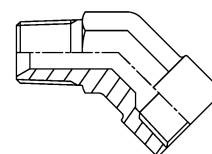
**T-stuk NPTF/NPTF**

bestelnr.	inw. NPTF	inw. NPTF	inw. NPTF
8777-02-02	1/8-27	1/8-27	1/8-27
8777-04-04	1/4-18	1/4-18	1/4-18
8777-06-06	3/8-18	3/8-18	3/8-18
8777-08-08	1/2-14	1/2-14	1/2-14
8777-12-12	3/4-14	3/4-14	3/4-14
8777-16-16	1-11,5	1-11,5	1-11,5
8777-20-20	1 1/4-11,5	1 1/4-11,5	1 1/4-11,5
8777-24-24	1 1/2-11,5	1 1/2-11,5	1 1/2-11,5

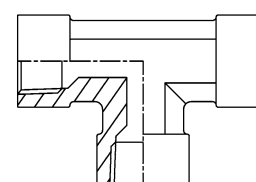
**Kniestuk 90° NPTF/NPTF**

bestelnr.	uitw. NPTF	inw. NPTF
8657-02-02	1/8-27	1/8-27
8657-04-04	1/4-18	1/4-18
8657-06-06	3/8-18	3/8-18
8657-08-08	1/2-14	1/2-14
8657-12-08	3/4-14	1/2-14
8657-12-12	3/4-14	3/4-14
8657-16-16	1-11,5	1-11,5
8657-20-20	1 1/4-11,5	1 1/4-11,5

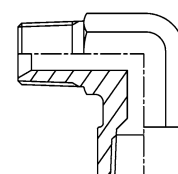

## T-stuk NPTF/NPTF

bestelnr.	inw. NPTF	uitw. NPTF
8775-02-02	1/8-27	1/8-27
8775-04-04	1/4-18	1/4-18
8775-06-06	3/8-18	3/8-18
8775-08-08	1/2-14	1/2-14
8775-12-12	3/4-14	3/4-14

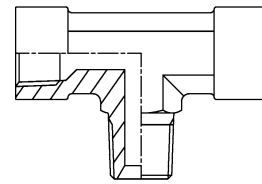

## T-stuk NPTF/NPTF

bestelnr.	inw. NPTF	uitw. NPTF
8776-02-02	1/8-27	1/8-27
8776-04-04	1/4-18	1/4-18
8776-06-06	3/8-18	3/8-18
8776-08-08	1/2-14	1/2-14
8776-12-12	3/4-14	3/4-14

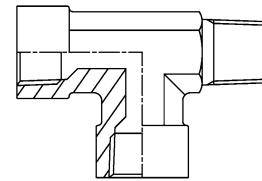

## Kruisstuk NPTF

bestelnr.	inw. NPTF
8377-02-02	1/8-27
8377-04-04	1/4-18
8377-06-06	3/8-18
8377-08-08	1/2-14
8377-12-12	3/4-14
8377-16-16	1-11,5
8377-20-20	1 1/4-11,5

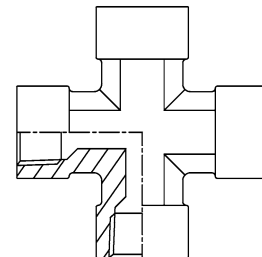

## Verbindingsnippel NPTF/NPSM

bestelnr.	uitw. NPTF	wartel NPSM
2257-02-02	1/8-27	1/8
2257-02-04	1/8-27	1/4
2257-04-04	1/4-18	1/4
2257-06-04	3/8-18	1/4
2257-04-06	1/4-18	3/8
2257-06-06	3/8-18	3/8
2257-08-06	1/2-14	3/8
2257-04-08	1/4-18	1/2
2257-06-08	3/8-18	1/2
2257-08-08	1/2-14	1/2
2257-12-08	3/4-14	1/2
2257-08-12	1/2-14	3/4
2257-12-12	3/4-14	3/4
2257-16-12	1-11,5	3/4
2257-12-16	3/4-14	1
2257-16-16	1-11,5	1
2257-20-16	1 1/4-11,5	1
2257-16-20	1-11,5	1 1/4
2257-20-20	1 1/4-11,5	1 1/4
2257-24-24	1 1/2-11,5	1 1/2
2257-32-32	2-11,5	2

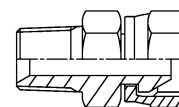

## Kniestuk 45° NPTF/NPSM

bestelnr.	uitw. NPTF	wartel NPSM
2457-02-02	1/8-27	1/8
2457-02-04	1/8-27	1/4
2457-04-04	1/4-18	1/4
2457-06-06	3/8-18	3/8
2457-06-08	3/8-18	1/2
2457-08-06	1/2-14	3/8
2457-08-08	1/2-14	1/2
2457-08-12	1/2-14	3/4
2457-12-08	3/4-14	1/2
2457-12-12	3/4-14	3/4
2457-12-16	3/4-14	1
2457-16-12	1-11,5	3/4
2457-16-16	1-11,5	1
2457-20-20	1 1/4-11,5	1 1/4
2457-24-24	1 1/2-11,5	1 1/2
2457-32-32	2-11,5	2

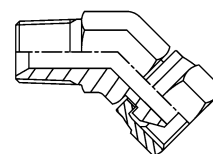



## Kniestuk 90° NPTF/NPSM

bestelnr.	uitw. NPTF	wartel NPSM
2657-02-02	1/8-27	1/8
2657-04-04	1/4-18	1/4
2657-06-04	3/8-18	1/4
2657-04-06	1/4-18	3/8
2657-06-06	3/8-18	3/8
2657-08-06	1/2-14	3/8
2657-06-08	3/8-18	1/2
2657-08-08	1/2-14	1/2
2657-08-12	1/2-14	3/4
2657-12-06	3/4-14	3/8
2657-12-08	3/4-14	1/2
2657-12-12	3/4-14	3/4
2657-12-16	3/4-14	1
2657-16-12	1-11,5	3/4
2657-16-16	1-11,5	1
2657-20-20	1 1/4-11,5	1 1/4
2657-24-24	1 1/2-11,5	1 1/2
2657-32-32	2-11,5	2

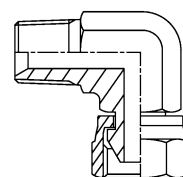

## Verbindingsnippel NPTF/NPSM

bestelnr.	inw. NPTF	wartel NPSM
2277-02-02	1/8-27	1/8
2277-04-04	1/4-18	1/4
2277-06-06	3/8-18	3/8
2277-08-08	1/2-14	1/2
2277-12-12	3/4-14	3/4
2277-16-16	1-11,5	1
2277-20-20	1 1/4-11,5	1 1/4
2277-24-24	1 1/2-11,5	1 1/2
2277-32-32	2-11,5	2

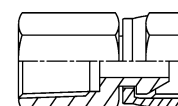

## Kniestuk 90° NPTF/NPSM

bestelnr.	inw. NPTF	wartel NPSM
2677-02-02	1/8-27	1/8
2677-04-04	1/4-18	1/4
2677-06-06	3/8-18	3/8
2677-08-08	1/2-14	1/2
2677-12-12	3/4-14	3/4
2677-16-16	1-11,5	1
2677-20-20	1 1/4-11,5	1 1/4
2677-24-24	1 1/2-11,5	1 1/2

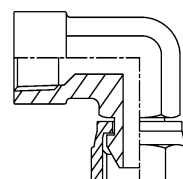

## Verbindingsnippel NPT/UNF

bestelnr.	uitw. UNF	wartel NPSM
8238-04-04	7/16-20	1/4
8238-06-04	9/16-18	1/4
8238-06-06	9/16-18	3/8
8238-08-06	3/4-16	3/8
8238-08-08	3/4-16	1/2
8238-10-08	7/8-14	1/2
8238-12-08	1 1/16-12	1/2
8238-12-12	1 1/16-12	3/4
8238-16-16	1 5/16-12	1
8238-20-20	1 5/8-12	1 1/4

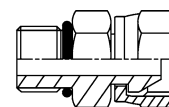

## Kniestuk 45° NPT/UNF

bestelnr.	uitw. UNF	wartel NPSM
8438-04-04	7/16-20	1/4
8438-06-06	9/16-18	3/8
8438-08-08	3/4-16	1/2
8438-10-08	7/8-14	1/2
8438-12-12	1 1/16-12	3/4
8438-16-16	1 5/16-12	1

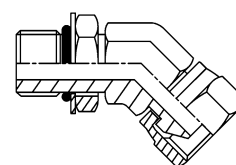

## Kniestuk 90° NPT/UNF

bestelnr.	uitw. UNF	wartel NPSM
8638-04-04	7/16-20	1/4
8638-06-04	9/16-18	1/4
8638-06-06	9/16-18	3/8
8638-08-06	3/4-16	3/8
8638-08-08	3/4-16	1/2
8638-10-08	7/8-14	1/2
8638-12-12	1 1/16-12	3/4
8638-16-16	1 5/16-12	1
8638-20-20	1 5/8-12	1 1/4

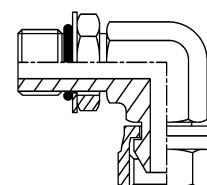

## Verbindingsnippel JIC/UNF

bestelnr.	uitw. UNF	wartel JIC
8242-04-04	7/16-20	7/16-20
8242-05-05	1/2-20	1/2-20
8242-06-06	9/16-18	9/16-18
8242-08-08	3/4-16	3/4-16
8242-10-10	7/8-14	7/8-14
8242-12-12	1 1/16-12	1 1/16-12
8242-16-16	1 5/16-12	1 5/16-12
8242-20-20	1 5/8-12	1 5/8-12

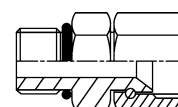

### Verbindingsnippel JIC/UNF

bestelnr.	uitw. JIC	uitw. UNF	pijpdia. [inch]	pijpdia. [mm]
8223-04-04	7/16-20	7/16-20	1/4	6
8223-04-05	7/16-20	1/2-20	1/4	6
8223-04-06	7/16-20	9/16-18	1/4	6
8223-05-05	1/2-20	1/2-20	5/16	8
8223-06-04	9/16-18	7/16-20	3/8	10
8223-06-06	9/16-20	9/16-20	3/8	10
8223-06-08	9/16-18	3/4-16	3/8	10
8223-08-06	3/4-16	9/16-18	1/2	12
8223-08-08	3/4-16	3/4-16	1/2	12
8223-08-10	3/4-14	7/8-14	1/2	12
8223-08-12	3/4-16	1 1/16-12	1/2	12
8223-10-08	7/8-14	3/4-16	5/8	14-15-16
8223-10-10	7/8-14	7/8-14	5/8	14-15-16
8223-10-12	7/8-14	1 1/16-12	5/8	14-15-16
8223-12-08	1 1/16-12	3/4-16	3/4	18-20
8223-12-10	1 1/16-12	7/8-14	3/4	18-20
8223-12-12	1 1/16-12	1 1/16-12	3/4	18-20
8223-12-16	1 1/16-12	1 5/16-12	3/4	18-20
8223-16-12	1 5/16-12	1 1/16-12	1	25
8223-16-16	1 5/16-12	1 5/16-12	1	25
8223-16-20	1 5/16-12	1 5/8-12	1	25
8223-20-20	1 5/8-12	1 5/8-12	1 1/4	30
8223-24-24	1 7/8-12	1 7/8-12	1 1/2	38

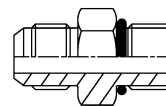

### Kniestuk 45° JIC/UNF

bestelnr.	uitw. JIC	uitw. UNF	pijpdia. [inch]	pijpdia. [mm]
8423-04-04	7/16-20	7/16-20	1/4	6
8423-05-05	1/2-20	1/2-20	5/16	8
8423-06-06	9/16-18	9/16-18	3/8	10
8423-06-08	9/16-18	3/4-16	3/8	10
8423-08-06	3/4-16	9/16-18	1/2	12
8423-08-08	3/4-16	3/4-16	1/2	12
8423-08-10	3/4-16	7/8-14	1/2	12
8423-10-08	7/8-14	3/4-16	5/8	16
8423-10-10	7/8-14	7/8-14	5/8	14-15-16
8423-12-10	1 1/16-12	7/8-14	3/4	18-20
8423-12-12	1 1/16-12	1 1/16-12	3/4	18-20
8423-16-16	1 5/16-12	1 5/16-12	1	25
8423-20-20	1 5/8-12	1 5/8-12	1 1/4	30-32
8423-24-24	1 7/8-12	1 7/8-12	1 1/2	38

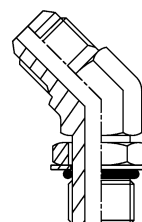

**Kniestuk 90° JIC/UNF**

bestelnr.	uitw. JIC	uitw. UNF	pijpdia. [inch]	pijpdia. [mm]
8623-04-04	7/16-20	7/16-20	1/4	6
8623-04-06	7/16-20	9/16-18	1/4	6
8623-05-05	1/2-20	1/2-20	5/16	8
8623-06-04	9/16-18	7/16-20	3/8	10
8623-06-06	9/16-18	9/16-18	3/8	10
8623-06-08	9/16-18	3/4-16	3/8	10
8623-08-06	3/4-16	9/16-18	1/2	12
8623-08-08	3/4-16	3/4-16	1/2	12
8623-08-10	3/4-16	7/8-14	5/8	12
8623-10-08	7/8-14	3/4-16	5/8	14-15-16
8623-10-10	7/8-14	7/8-14	5/8	14-15-16
8623-12-10	1 1/16-12	7/8-14	3/4	18-20
8623-12-12	1 1/16-12	1 1/16-12	3/4	18-20
8623-16-12	1 5/16-12	1 1/16-12	1	25
8623-16-16	1 5/16-12	1 5/16-12	1	25
8623-16-20	1 5/16-12	1 5/8-12	1	25
8623-20-20	1 5/8-12	1 5/8-12	1 1/4	30-32
8623-24-24	1 7/8-12	1 7/8-12	1 1/2	38

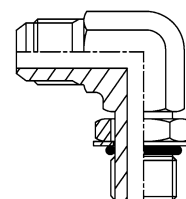
**T-stuk JIC/UNF**

bestelnr.	uitw. JIC	uitw. UNF	pijpdia. [inch]	pijpdia. [mm]
2523-04-04	7/16-20	7/16-20	1/4	6
2523-05-05	1/2-20	1/2-20	5/16	8
2523-06-06	9/16-18	9/16-18	3/8	10
2523-08-08	3/4-16	3/4-16	1/2	12
2523-10-10	7/8-14	7/8-14	5/8	14-15-16
2523-12-12	1 1/16-12	1 1/16-12	3/4	18-20
2523-16-16	1 5/16-12	1 5/16-12	1	25

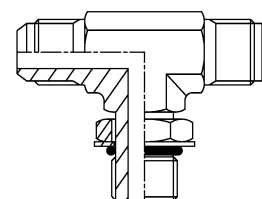
**T-stuk JIC/UNF**

bestelnr.	uitw. JIC	uitw. UNF	pijpdia. [inch]	pijpdia. [mm]
2522-04-04	7/16-20	7/16-20	1/4	6
2522-05-05	1/2-20	1/2-20	5/16	8
2522-06-06	9/16-18	9/16-18	3/8	10
2522-08-08	3/4-16	3/4-16	1/2	12
2522-10-10	7/8-14	7/8-14	5/8	14-15-16
2522-12-12	1 1/16-12	1 1/16-12	3/4	18-20
2522-16-16	1 5/16-12	1 5/16-12	1	25

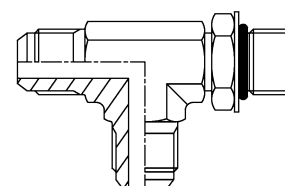
**Moer JIC**

bestelnr.	inw. JIC	pijpdia.. [inch]	pijpdia. [mm]
8140-04	7/16-20	1/4	6
8140-05	1/2-20	5/16	8
8140-06	9/16-18	3/8	10
8140-08	3/4-16	1/2	12
8140-10	7/8-14	5/8	15
8140-12	1 1/16-12	3/4	18
8140-16	1 5/16-12	1	25
8140-20	1 5/8-12	1 1/4	30
8140-24	1 7/8-12	1 1/2	38



## Steunhuls Inch

bestelnr.	pijpdia. [inch]	L [mm]
8120-04	1/4	10
8120-05	5/16	11
8120-06	3/8	13
8120-08	1/2	14
8120-10	5/8	17
8120-12	3/4	17
8120-16	1	20
8120-20	1 1/4	23
8120-24	1 1/2	28

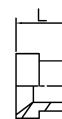

## Steunhuls Metrisch

bestelnr.	pijpdia. [mm]	L [mm]
8180-06	6	10
8180-08	8	11
8180-10	10	13
8180-12	12	14
8180-14	14	14
8180-15	15	14
8180-16	16	14
8180-18	18	14
8180-20	20	14
8180-25	25	20
8180-30	30	23
8180-32	32	23
8180-38	38	28

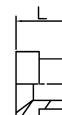

## Dubbelnippel JIC/JIC

bestelnr.	uitw. JIC	pijpdia. [inch]	pijpdia. [mm]
2222-04-04	7/16-20	1/4	6
2222-05-05	1/2-20	5/16	8
2222-06-06	9/16-18	3/8	10
2222-08-08	3/4-16	1/2	12
2222-10-10	7/8-14	5/8	14-15-16
2222-12-12	1 1/16-12	3/4	18-20
2222-16-16	1 5/16-12	1	25
2222-20-20	1 5/8-12	1 1/4	30-32
2222-24-24	1 7/8-12	1 1/2	38
2222-32-32	2 1/2-12	2	

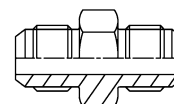

## Schotverbinding JIC/JIC

bestelnr.	uitw. JIC	pijpdia. [inch]	pijpdia. [mm]
8226-04-04	7/16-20	1/4	6
8226-05-05	1/2-20	5/16	8
8226-06-06	9/16-18	3/8	10
8226-08-08	3/4-16	1/2	12
8226-10-10	7/8-14	5/8	14-15-16
8226-12-12	1 1/16-12	3/4	18-20
8226-16-16	1 5/16-12	1	25
8226-20-20	1 5/8-12	1 1/4	30-32
8226-24-24	1 7/8-12	1 1/2	38

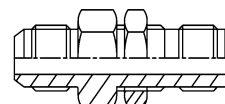

Maximum schotdikte = 9,5 mm.

## Plug JIC

bestelnr.	uitw. JIC	pijpdia. [inch]	pijpdia. [mm]
2120-04	7/16-20	1/4	6
2120-05	1/2-20	5/16	8
2120-06	9/16-18	3/8	10
2120-08	3/4-16	1/2	12
2120-10	7/8-14	5/8	14-15-16
2120-12	1 1/16-12	3/4	18-20
2120-16	1 5/16-12	1	25
2120-20	1 5/8-12	1 1/4	30-32
2120-24	1 7/8-12	1 1/2	38

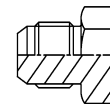

## Blindkap JIC

bestelnr.	wartel JIC	pijpdia. [inch]	pijpdia. [mm]
2115-04	7/16-20	1/4	6
2115-05	1/2-20	5/16	8
2115-06	9/16-18	3/8	10
2115-08	3/4-16	1/2	12
2115-10	7/8-14	5/8	14-15-16
2115-12	1 1/16-12	3/4	18-20
2115-16	1 5/16-12	1	25
2115-20	1 5/8-12	1 1/4	30-32
2115-24	1 7/8-12	1 1/2	38

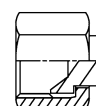

## Verbindingsnippel JIC

bestelnr.	wartel JIC	wartel JIC
2215-04-04	7/16-20	7/16-20
2215-05-05	1/2-20	1/2-20
2215-06-04	9/16-18	7/16-20
2215-06-06	9/16-18	9/16-18
2215-08-06	3/4-16	9/16-18
2215-08-08	3/4-16	3/4-16
2215-12-05	1 1/16-12	1/2-20
2215-12-08	1 1/16-12	3/4-16
2215-12-10	1 1/16-12	7/8-14
2215-12-12	1 1/16-12	1 1/16-12
2215-16-16	1 5/16-12	1 5/16-12

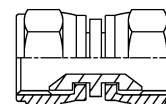

### Verloopnippel JIC/JIC

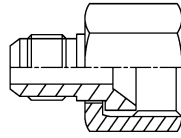

bestelnr.	uitw. JIC	inw. JIC	pijpdia. [inch]	pijpdia. [inch]	pijpdia. [mm]	pijpdia. [mm]
8224-04-06	7/16-20	9/16-18	1/4	3/8	6	10
8224-05-06*	1/2-20	9/16-18	5/16	3/8	8	10
8224-04-08	7/16-20	3/4-16	1/4	1/2	6	12
8224-05-08	1/2-20	3/4-16	5/16	1/2	8	12
8224-06-08	9/16-18	3/4-16	3/8	1/2	10	12
8224-04-10	7/16-20	7/8-14	1/4	5/8	6	14-15-16
8224-06-10	9/16-18	7/8-14	3/8	5/8	10	14-15-16
8224-08-10	3/4-16	7/8-14	1/2	5/8	12	14-15-16
8224-04-12	7/16-20	1 1/16-12	1/4	3/4	6	18-20
8224-06-12	9/16-18	1 1/16-12	3/8	3/4	10	18-20
8224-08-12	3/4-16	1 1/16-12	1/2	3/4	12	18-20
8224-10-12	7/18-14	1 1/16-12	5/8	3/4	14-15-16	18-20
8224-12-16	1 1/16-12	1 5/16-12	3/4	1	18-20	25
8224-12-20	1 1/16-12	1 5/8-12	3/4	1 1/4	18-20	30-32
8224-16-20	5/16-12	1 5/8-12	1	1 1/4	25	30-32
8224-20-24	1 5/8-12	17/8-12	1 1/4	1 1/2	30-32	38

**Knieschotverbinding 45° JIC/JIC**

bestelnr.	uitw. JIC	pijpdia. [inch]	pijpdia. [mm]
8426-04-04	7/16-20	1/4	6
8426-06-06	9/16-18	3/8	10
8426-08-08	3/4-16	1/2	12
8426-10-10	7/8-14	5/8	14-15-16
8426-12-12	1 1/16-12	3/4	18-20
8426-16-16	1 5/16-12	1	25

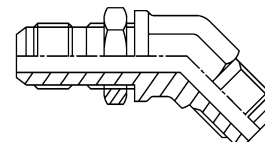
**Kniestuk 45° JIC/JIC**

bestelnr.	uitw. JIC	wartel JIC	pijpdia. [inch]	pijpdia. [mm]
8424-04-04	7/16-20	7/16-20	1/4	6
8424-05-05	1/2-20	1/2-20	5/16	8
8424-06-06	9/16-18	9/16-18	3/8	10
8424-08-08	3/4-16	3/4-16	1/2	12
8424-10-10	7/8-14	7/8-14	5/8	14-15-16
8424-12-12	1 1/16-12	1 1/16-12	3/4	18-20
8424-16-16	1 5/16-12	1 5/16-12	1	25
8424-20-20	1 5/8-12	1 5/8-12	1 1/4	30-32

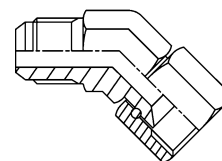
**Kniestuk 90° JIC/JIC**

bestelnr.	uitw. JIC	pijpdia. [inch]	pijpdia. [mm]
2622-04-04	7/16-20	1/4	6
2622-05-05	1/2-20	5/16	8
2622-06-06	9/16-18	3/8	10
2622-08-08	3/4-16	1/2	12
2622-10-10	7/8-14	5/8	14-15-16
2622-12-12	1 1/16-12	3/4	18-20
2622-16-16	1 5/16-12	1	25
2622-20-20	1 5/8-12	1 1/4	30-32
2622-24-24	1 7/8-12	1 1/2	38

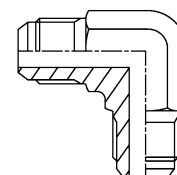
**Kniestuk 90° JIC/JIC**

bestelnr.	uitw. JIC	wartel JIC	pijpdia. [inch]	pijpdia. [mm]
8624-04-04	7/16-20	7/16-20	1/4	6
8624-05-05	1/2-20	1/2-20	5/16	8
8624-06-06	9/16-18	9/16-18	3/8	10
8624-08-08	3/4-16	3/4-16	1/2	12
8624-10-10	7/8-14	7/8-14	5/8	14-15-16
8624-12-12	1 1/16-12	1 1/16-12	3/4	18-20
8624-16-16	1 5/16-12	1 5/16-12	1	25
8624-20-20	1 5/8-12	1 5/8-12	1 1/4	30-32
8624-24-24	1 7/8-12	1 7/8-12	1 1/2	38

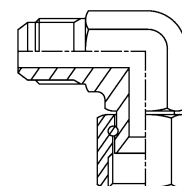



## Knieschotverbinding 90° JIC/JIC

bestelnr.	uitw. JIC	pijpdia. [inch]	pijpdia. [mm]
8626-04-04	7/16-20	1/4	6
8626-05-05	1/2-20	5/16	8
8626-06-06	9/16-18	3/8	10
8626-08-08	3/4-16	1/2	12
8626-10-10	7/8-14	5/8	14-15-16
8626-12-12	1 1/16-12	3/4	18-20
8626-16-16	1 5/16-12	1	25
8626-20-20	1 5/8-12	1 1/4	30-32

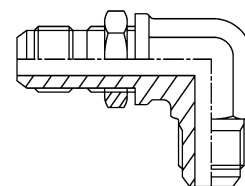

## T-stuk JIC/JIC

bestelnr.	JIC	pijpdia. [inch]	pijpdia. [mm]
2722-04-04	7/16-20	1/4	6
2722-05-05	1/2-20	5/16	8
2722-06-06	9/16-18	3/8	10
2722-08-08	3/4-16	1/2	12
2722-10-10	7/8-14	5/8	14-15-16
2722-12-12	1 1/16-12	3/4	18-20
2722-16-16	1 5/16-12	1	25
2722-20-20	1 5/8-12	1 1/4	30-32
2722-24-24	1 7/8-12	1 1/2	38

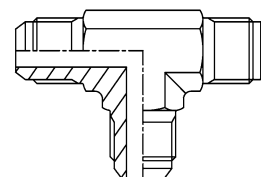

## T-schotverbindingprkg JIC/JIC

bestelnr.	uitw. JIC	pijpdia. [inch]	pijpdia. [mm]
8526-04-04	7/16-20	1/4	6
8526-06-06	9/16-18	3/8	10
8526-08-08	3/4-16	1/2	12
8526-10-10	7/8-14	5/8	14
8526-12-12	1 1/16-12	5/8	15

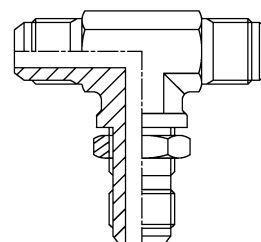

## T-stuk JIC/JIC

bestelnr.	uitw. JIC	wartel JIC	pijpdia. [inch]	pijpdia. [mm]
2520-04-04	7/16-20	7/16-20	1/4	6
2520-06-06	9/16-18	9/16-18	3/8	10
2520-08-08	3/4-16	3/4-16	1/2	12
2520-10-10	7/8-14	7/8-14	5/8	14-15-16
2520-12-12	1 1/16-12	1 1/16-12	3/4	18-20
2520-16-16	1 5/16-12	1 5/16-12	1	25
2520-20-20	1 5/8-12	1 5/8-12	1 1/4	30-32

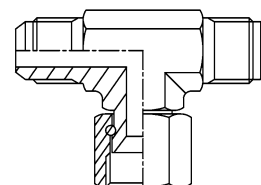

## T-stuk JIC/JIC

bestelnr.	uitw. JIC	wartel JIC	pijpdia. [inch]	pijpdia. [mm]
2540-04-04	7/16-20	7/16-20	1/4	6
2540-06-06	9/16-18	9/16-18	3/8	10
2540-08-08	3/4-16	3/4-16	1/2	12
2540-10-10	7/8-14	7/8-14	5/8	14-15-16
2540-12-12	1 1/16-12	1 1/16-12	3/4	18-20
2540-16-16	1 5/16-12	1 5/16-12	1	25
2540-20-20	1 5/8-12	1 5/8-12	1 1/4	30-32

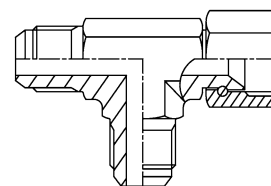

## Kruisstuk JIC/JIC

bestelnr.	JIC	pijpdia. [inch]	pijpdia. [mm]
2720-04-04	7/16-20	1/4	6
2720-05-05	1/2-20	5/16	8
2720-06-06	9/16-18	3/8	10
2720-08-08	3/4-16	1/2	12
2720-10-10	7/8-14	5/8	14-15-16
2720-12-12	1 1/16-12	3/4	18-20

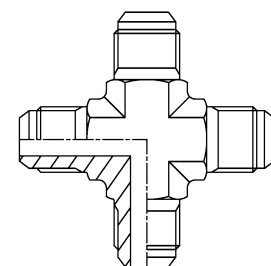

## Verbindingsnippel JIC/NPTF

bestelnr.	pijpdia. [inch]	pijpdia. [mm]	uitw. NPTF	uitw. JIC
2225-02-04	1/4	6	1/8	7/16-20
2225-04-04	1/4	6	1/4	7/16-20
2225-02-05	5/16	8	1/8	1/2-20
2225-04-05	5/16	8	1/4	1/2-20
2225-02-06	3/8	10	1/8	9/16-18
2225-04-06	3/8	10	1/4	9/16-18
2225-06-06	3/8	10	3/8	9/16-18
2225-08-06	3/8	10	1/2	9/16-18
2225-04-08	1/2	12	1/4	3/4-16
2225-06-08	1/2	12	3/8	3/4-16
2225-08-08	1/2	12	1/2	3/4-16
2225-12-08	1/2	12	3/4	3/4-16
2225-06-10	5/8	14	3/8	7/8-14
2225-12-10	5/8	14	3/4	7/8-14
2225-06-10	5/8	15	3/8	7/8-14
2225-08-10	5/8	15	1/2	7/8-14
2225-12-10	5/8	15	3/4	7/8-14
2225-06-10	5/8	16	3/8	7/8-14
2225-12-10	5/8	16	3/4	7/8-14
2225-08-12	3/4	18	1/2	1 1/16-12
2225-12-12	3/4	18-20	3/4	1 1/16-12
2225-16-12	3/4	18	1	1 1/16-12
2225-08-12	3/4	20	1/2	1 1/16-12
2225-16-12	3/4	20	1	1 1/16-12
2225-12-14	7/8	0	3/4	13/16-12
2225-12-16	1	25	3/4	1 5/16-12
2225-16-16	1	25	1	1 5/16-12
2225-16-20	1 1/4	30	1	1 5/8-12
2225-20-20	1 1/4	30	1 1/4	1 5/8-12
2225-16-20	1 1/4	32	1	1 5/8-12
2225-20-24	1 1/2	38	1 1/4	1 7/8-12
2225-24-24	1 1/2	38	1 1/2	1 7/8-12
2225-24-32	2		1 1/2	2 1/2-12
2225-32-32	2		2	2 1/2-12

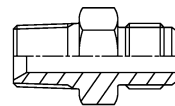

## Verbindingsnippel NPTF/JIC

bestelnr.	uitw. NPTF	wartel JIC
8254-02-04	1/8	7/16-20
8254-02-05	1/8	1/2-20
8254-04-04	1/4	7/16-20
8254-04-05	1/4	1/2-20
8254-04-06	1/4	9/16-18
8254-04-08	1/4	3/4-16
8254-06-06	3/8	9/16-18
8254-06-08	3/8	3/4-16
8254-06-10	3/8	7/8-14
8254-08-10	1/2	7/8-14
8254-08-12	1/2	1 1/16-12
8254-12-12	3/4	11/16
8254-12-16	3/4	15/16

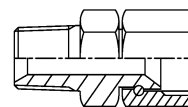

## Verbindingsnippel JIC/NPTF

bestelnr.	inw. NPTF	uitw. JIC	pijpdia. [mm]	pijpdia. [mm]
8227-02-04	1/8	7/16-20	1/4	6
8227-04-04	1/4	7/16-20	1/4	6
8227-02-05	1/8	1/2-20	5/16	8
8227-04-05	1/4	1/2-20	5/16	8
8227-04-06	1/4	9/16-18	3/8	10
8227-06-06	3/8	9/16-18	3/8	10
8227-06-08	3/8	3/4-16	1/2	12
8227-08-08	1/2	3/4-16	1/2	12
8227-08-10	1/2	7/8-14	5/8	14-15-16
8227-08-12	1/2	1 1/16-12	3/4	18-20
8227-12-12	3/4	1 1/16-12	3/4	18-20
8227-16-16	1	1 5/16-12	1	25
8227-20-20	1 1/4	1 5/8-12	1 1/4	30-32
8227-24-24	1 1/2	1 7/8-12	1 1/2	38

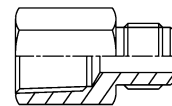

## Kniestuk 45° JIC/NPTF

bestelnr.	uitw. NPTF	uitw. JIC	pijpdia. [inch]	pijpdia. [mm]
2425-02-04	1/8	7/16-20	1/4	6
2425-04-04	1/4	7/16-20	1/4	6
2425-02-05	1/8	1/2-20	5/16	8
2425-04-05	1/4	1/2-20	5/16	8
2425-02-06	1/8	9/16-18	3/8	10
2425-04-06	1/4	9/16-18	3/8	10
2425-06-06	3/8	9/16-18	3/8	10
2425-08-06	1/2	9/16-18	3/8	10
2425-04-08	1/4	3/4-16	1/2	12
2425-06-08	3/8	3/4-16	1/2	12
2425-08-08	1/2	3/4-16	1/2	12
2425-12-08	3/4	3/4-16	1/2	12
2425-06-10	3/8	7/8-14	5/8	14-15-16
2425-08-10	1/2	7/8-14	5/8	14-15-16
2425-12-10	3/4	7/8-14	5/8	16
2425-08-12	1/2	1 1/16-12	3/4	18
2425-12-12	3/4	1 1/16-12	3/4	18-20
2425-08-12	1/2	1 1/16-12	3/4	20
2425-12-14	3/4	1 3/16-12	7/8	
2425-16-12	1	1 1/16-12	3/4	20
2425-12-16	3/4	1 5/16-12	1	25
2425-16-16	1	1 5/16-12	1	25
2425-16-20	1	1 5/8-12	1 1/4	30
2425-20-20	1 1/4	1 5/8-12	1 1/4	30-32
2425-24-24	1 1/2	1 7/8-12	1 1/2	38
2425-32-32	2	2 1/2-12	2	

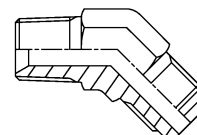

## Kniestuk 90° JIC/NPTF

bestelnr.	uitw. NPTF	uitw. JIC	pijpdia. [inch]	pijpdia. [mm]
2625-02-04	1/8	7/16-20	1/4	6
2625-04-04	1/4	7/16-20	1/4	6
2625-02-05	1/8	1/2-20	5/16	8
2625-04-05	1/4	1/2-20	5/16	8
2625-02-06	1/8	9/16-18	3/8	10
2625-04-06	1/4	9/16-18	3/8	10
2625-06-06	3/8	9/16-18	3/8	10
2625-08-06	1/2	9/16-18	3/8	10
2625-04-08	1/4	3/4-16	1/2	12
2625-06-08	3/8	3/4-16	1/2	12
2625-08-08	1/2	3/4-16	1/2	12
2625-12-08	3/4	3/4-16	1/2	12
2625-06-10	3/8	7/8-14	5/8	14-15-16
2625-08-10	1/2	7/8-12	5/8	14-15-16
2625-12-10	3/4	7/8-14	5/8	14-15-16
2625-12-12	3/4	1 1/16-12	3/4	20
2625-08-12	1/2	1 1/16-12	3/4	18-20
2625-16-12	1	1 1/16-12	3/4	20
2625-12-14	3/4	1 3/16-12	7/8	
2625-12-16	3/4	1 5/16-12	1	25
2625-16-16	1	1 5/16-12	1	25
2625-16-20	1	1 5/8-12	1 1/4	30-32
2625-20-20	1 1/4	1 5/8-12	1 1/4	30-32
2625-24-24	1 1/2	1 7/8-12	1 1/2	38
2625-32-32	2	2 1/2-12	2	

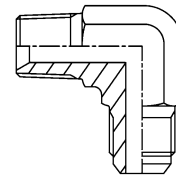

## Kniestuk 90° JIC/NPTF

bestelnr.	inw. NPTF	uitw. JIC	pijpdia. [inch]	pijpdia. [mm]
8627-02-04	1/8	7/16-20	1/4	6
8627-04-04	1/4	7/16-20	1/4	6
8627-02-05	1/8	1/2-20	5/16	8
8627-04-05	1/4	1/2-20	5/16	8
8627-02-06	1/8	9/16-18	3/8	10
8627-04-06	1/4	9/16-18	3/8	10
8627-06-06	3/8	9/16-18	3/8	10
8627-04-08	1/4	3/4-16	1/2	12
8627-06-08	3/8	3/4-16	1/2	12
8627-08-08	1/2	3/4-16	1/2	12
8627-08-10	1/2	7/8-14	5/8	14-15-16
8627-08-12	1/2	1 1/16-12	3/4	18-20
8627-12-12	3/4	1 1/16-12	3/4	18-20
8627-16-16	1	1 5/16-12	1	25
8627-20-20	1 1/4	1 5/8-12	1 1/4	30-32
8627-24-24	1 1/2	1 7/8-12	1 1/2	38

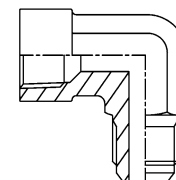

## T-stuk JIC/NPTF

bestelnr.	uitw. JIC	uitw. NPTF	pijpdia. [inch]	pijpdia. [mm]
2530-04-02	7/16-20	1/8	1/4	6
2530-05-02	1/2-20	1/8	5/16	8
2530-06-04	9/16-18	1/4	3/8	10
2530-08-06	3/4-16	3/8	1/2	12
2530-10-08	7/8-14	1/2	5/8	14-15-16
2530-12-12	11/16-12	3/4	3/4	18-20
2530-16-16	15/16-12	1	1	25
2530-20-20	15/8-12	1 1/4	1 1/4	30-32

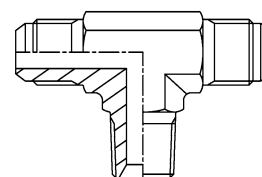

## T-stuk JIC/NPTF

bestelnr.	uitw. JIC	uitw. NPTF	pijpdia. [inch]	pijpdia. [mm]
2531-04-02	7/16-20	1/8	1/4	6
2531-05-02	1/2-20	1/8	5/16	8
2531-06-04	9/16-18	1/4	3/8	10
2531-08-06	3/4-16	3/8	1/2	12
2531-10-08	7/8-14	1/2	5/8	14-15-16
2531-12-12	1 1/16-12	3/4	3/4	18-20
2531-16-16	1 5/16-12	1	1	25
2531-20-20	1 5/8-12	1 1/4	1 1/4	30-32

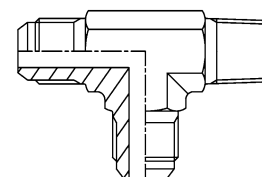

## T-stuk JIC/NPTF

bestelnr.	uitw. JIC	inw. NPTF	pijpdia. [inch]	pijpdia. [mm]
8727-04-02	7/16-20	1/8	1/4	6
8727-05-02	1/2-20	1/8	5/16	8
8727-06-04	9/16-18	1/4	3/8	10
8727-08-06	3/4-16	3/8	1/2	12
8727-10-08	7/8-14	1/2	5/8	14
8727-10-08	7/8-14	1/2	5/8	15
8727-10-08	7/8-14	1/2	5/8	16
8727-12-12	1 1/16-12	3/4	3/4	18
8727-12-12	1 1/16-12	3/4	3/4	20
8727-16-16	1 5/16-12	1	1	25
8727-20-20	1 5/8-12	1 1/4	1 1/4	30
8727-20-20	1 5/8-12	1 1/4	1 1/4	32
8727-24-24	1 7/8-12	1 1/2	1 1/2	38

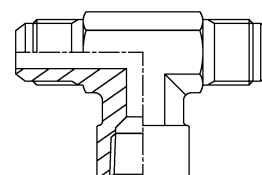

## T-stuk JIC/NPTF

bestelnr.	uitw. JIC	inw. NPTF	pijpdia. [inch]	pijpdia. [mm]
8728-06-04	9/16-18	1/4	3/8	10
8728-08-06	3/4-16	3/8	1/2	12
8728-10-08	7/8-14	1/2	5/8	14-15-16
8728-12-12	1 1/16-12	3/4	3/4	18-20
8728-16-16	1 5/16-12	1	1	25
8728-20-20	1 5/8-12	1 1/4	1 1/4	30-32

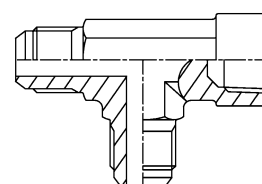

## Verbindingsnippel JIC/BSP

bestelnr.	uitw. JIC	uitw. BSP	pijpdia. [inch]	pijpdia. [mm]
2224-04-02	7/16-20	1/8	1/4	6
2224-04-04	7/16-20	1/4	1/4	6
2224-04-06	7/16-20	3/8	1/4	6
2224-04-08	7/16-20	1/2	1/4	6
2224-05-04	1/2-20	1/4	5/16	8
2224-05-06	1/2-20	3/8	5/16	8
2224-06-04	9/16-18	1/4	3/8	10
2224-06-06	9/16-18	3/8	3/8	10
2224-06-08	9/16-18	1/2	3/8	10
2224-08-04	3/4-16	1/4	1/2	12
2224-08-06	3/4-16	3/8	1/2	12
2224-08-08	3/4-16	1/2	1/2	12
2224-08-12	3/4-16	3/4	1/2	12
2224-10-06	7/8-14	3/8	5/8	14-15-16
2224-10-08	7/8-14	1/2	5/8	14-15-16
2224-12-08	1 1/16-12	1/2	3/4	18
2224-12-12	1 1/16-12	3/4	3/4	18-20
2224-12-16	1 1/16-12	1	3/4	18-20
2224-12-08	1 1/16-12	1/2	3/4	20
2224-16-12	1 5/16-12	3/4	1	25
2224-16-16	1 5/16-12	1	1	25
2224-16-20	1 5/16-12	1 1/4	1	25
2224-20-20	1 5/8-12	1 1/4	1 1/4	30-32
2224-24-20	1 7/8-12	1 1/4	1 1/2	38
2224-24-24	1 7/8-12	1 1/2	1 1/2	38

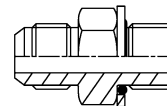

## Adapter JIC/BSP(ED)

bestelnr.	uitw. JIC	uitw. BSP(ED)	pijpdia. [inch]	pijpdia. [mm]
2224-04-04ED	7/16-20	1/4-19	1/4	6
2224-06-04ED	9/16-18	1/4-19	3/8	10
2224-06-06ED	9/16-18	3/8-19	3/8	10
2224-08-08ED	3/4-16	1/2-14	1/2	12
2224-08-12ED	3/4-16	3/4-14	1/2	12
2224-12-08ED	1 1/16-12	1/2-14	3/4	18-20
2224-12-12ED	1 1/16-12	3/4-14	3/4	18-20
2224-12-16ED	1 1/16-12	1-11	1	25
2224-16-16ED	1 5/16-12	1-11	1	25

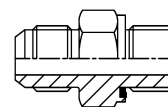

## Verbindingsnippel JIC/BSP

bestelnr.	inw. JIC	uitw. BSP
8241-04-02	7/16-20	1/8
8241-05-04	1/2-20	1/4
8241-06-04	9/16-18	1/4
8241-06-06	9/16-18	3/8
8241-08-06	3/4-16	3/8
8241-10-08	7/8-14	1/2
8241-12-12	1 1/16-12	3/4
8241-16-16	1 5/16-12	1
8241-20-20	1 5/8-12	1 1/4
8241-24-24	1 7/8-12	1 1/2

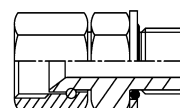

## Verbindingsnippel JIC/BSP

bestelnr.	uitw. JIC	inw. BSP	pijpdia. [inch]	pijpdia. [mm]
2221-04-02	7/16-20	1/8	1/4	6
2221-04-04	7/16-20	1/4	1/4	6
2221-05-02	1/2-20	1/8	5/16	8
2221-06-04	9/16-18	1/4	3/8	10
2221-06-06	9/16-18	3/8	3/8	10
2221-08-06	3/4-16	3/8	1/2	12
2221-08-08	3/4-16	1/2	1/2	12
2221-10-08	7/8-14	1/2	5/8	14-15-16
2221-12-12	1 1/16-12	3/4	3/4	18-20
2221-16-16	1 5/16-12	1	1	25

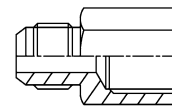

## Kniestuk 45° JIC/BSP

bestelnr.	uitw. JIC	uitw. BSP	pijpdia. [inch]	pijpdia. [mm]
2424-04-02	7/16-20	1/8	1/4	6
2424-06-04	9/16-18	1/4	3/8	10
2424-08-06	3/4-16	3/8	1/2	12
2424-10-08	7/8-14	1/2	5/8	14-15-16
2424-12-12	1 1/16-12	3/4	3/4	18-20
2424-16-16	1 5/16-12	1	1	25

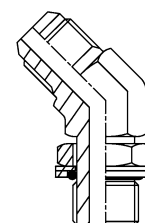

## Kniestuk 90° JIC/BSP

bestelnr.	uitw. JIC	uitw. BSP	pijpdia. [inch]	pijpdia. [mm]
2624-04-02	7/16-20	1/8	1/4	6
2624-04-04	7/16-20	1/4	1/4	6
2624-05-04	1/2-20	1/4	5/16	8
2624-06-04	9/16-18	1/4	3/8	10
2624-06-06	9/16-18	3/8	3/8	10
2624-08-04	3/4-16	1/4	1/2	12
2624-08-06	3/4-16	3/8	1/2	12
2624-08-08	3/4-16	1/2	1/2	12
2624-10-08	7/8-14	1/2	5/8	14-15-16
2624-12-08	1 1/16-12	1/2	3/4	18-20
2624-12-12	1 1/16-12	3/4	3/4	18-20
2624-16-12	1 5/16-12	3/4	1	25
2624-16-16	1 5/16-12	1	1	25
2624-20-16	1 5/8-12	1	1 1/4	30-32
2624-20-20	1 5/8-12	1 1/4	1 1/4	30-32
2624-24-24	1 7/8-12	1 1/2	1 1/2	38

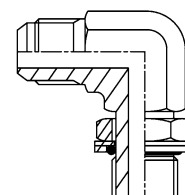

## T-stuk JIC/BSP

bestelnr.	uitw. JIC	uitw. BSP	pijpdia. [inch]	pijpdia. [mm]
2524-04-02	7/16-20	1/8	1/4	6
2524-06-04	9/16-18	1/4	3/8	10
2524-08-06	3/4-16	3/8	1/2	12
2524-10-08	7/8-14	1/2	5/8	14-15-16
2524-12-12	1 1/16-12	3/4	3/4	18-20

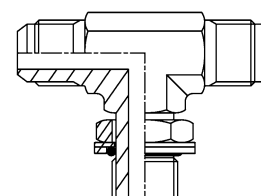



### T-stuk JIC/BSP

bestelnr.	uitw. JIC	uitw. BSP	pijpdia. [inch]	pijpdia. [mm]
2525-06-04	9/16-18	1/4	3/8	10
2525-08-06	3/4-16	3/8	1/2	12
2525-10-08	7/8-14	1/2	5/8	14-15-16
2525-12-12	1 1/16-12	3/4	3/4	18-20

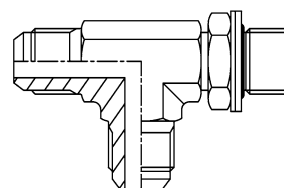

### Verbindingsnippel JIC/Metrisch

bestelnr.	uitw. JIC	uitw. metrisch	pijpdia. [inch]	pijpdia. [mm]
2226-04-10	7/16-20	M10 x 1	1/4	6
2226-05-12	1/2-20	M12 x 1,5	5/16	8
2226-06-14	9/16-18	M14 x 1,5	3/8	10
2226-08-16	3/4-16	M16 x 1,5	1/2	12
2226-08-18	3/4-16	M18 x 1,5	1/2	12
2226-10-18	7/8-14	M18 x 1,5	5/8	14-15-16
2226-10-22	7/8-14	M22 x 1,5	5/8	14-15-16
2226-12-22	1 1/16-12	M22 x 1,5	3/4	18-20
2226-12-27	1 1/16-12	M27 x 2	3/4	18-20
2226-16-33	1 5/16-12	M33 x 2	1	25
2226-20-42	1 5/8-12	M42 x 2	1 1/4	30-32
2226-24-50	1 7/8-12	M50 x 2	1 1/2	38

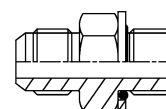

### Verbindingsnippel JIC/Metrisch

bestelnr.	inw. JIC	uitw. metrisch
8249-04-10	7/16-20	M10 x 1
8249-05-12	1/2-20	M12 x 1,5
8249-06-14	9/16-18	M14 x 1,5
8249-08-16	3/4-16	M16 x 1,5
8249-10-22	7/8-14	M22 x 1,5
8249-12-27	1 1/16-12	M27 x 2
8249-16-33	1 5/16-12	M33 x 2
8249-20-42	1 5/8-12	M42 x 2
8249-24-50	1 7/8-12	M50 x 2

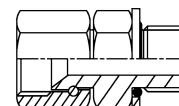

### Kniestuk 90° JIC/Metrisch

bestelnr.	JIC	metrisch	pijpdia. [inch]	pijpdia. [mm]
2626-04-10	7/16-20	M10 x 1	1/4	6
2626-05-12	1/2-20	M12 x 1,5	5/16	8
2626-06-14	9/16-18	M14 x 1,5	3/8	10
2626-08-16	3/4-16	M16 x 1,5	1/2	12
2626-10-18	7/8-14	M18 x 1,5	5/8	14-15-16
2626-10-22	7/8-14	M22 x 1,5	5/8	14-15-16
2626-10-18	7/8-14	M18 x 1,5	5/8	16
2626-10-22	7/8-14	M22 x 1,5	5/8	16
2626-12-22	1 1/16-12	M22 x 1,5	3/4	18-20
2626-12-27	1 1/16-12	M27 x 2	3/4	18-20
2626-16-33	1 5/16-12	M33 x 2	1	25
2626-20-42	1 5/8-12	M42 x 2	1 1/4	30-32

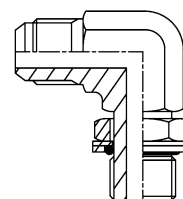

## Dubbelnippel Metrisch/BSP

bestelnr.	uitw. metrisch	uitw. BSP
2284-12-02	12 x 1,5	1/8-28
2284-12-04	12 x 1,5	1/4-19
2284-14-04	14 x 1,5	1/4-19
2284-14-06	14 x 1,5	3/8-19
2284-16-04	16 x 1,5	1/4-19
2284-16-06	16 x 1,5	3/8-19
2284-18-06	18 x 1,5	3/8-19
2284-18-08	18 x 1,5	1/2-14
2284-22-08	22 x 1,5	1/2-14
2284-26-08	26 x 1,5	1/2-14
2284-26-12	26 x 1,5	3/4-14
2284-30-12	30 x 1,5	3/4-14
2284-38-16	38 x 1,5	1-11

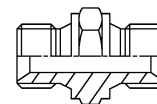

## Verloopring Metrisch/BSP

bestelnr.	inw.	uitw.	type
8246-04-14	1/4-19	M14x1,5	II
8246-04-18	1/4-19	M18 x 1,5	II
8246-06-18	3/8-19	M18 x 1,5	II
8246-08-18	1/2-14	M18 x 1,5	I
8246-08-22	1/2-14	M22 x 1,5	II
8246-14-08	1/2-14	M14 x 1,5	II
8246-18-04	M18 x 1,5	1/4-19	I
8246-18-06	M18 x 1,5	3/8-19	II
8246-18-08	M18 x 1,5	1/2-14	II
8246-18-12	M18 x 1,5	3/4-14	II
8246-22-08	M22 x 1,5	1/2-14	II

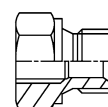

Type I

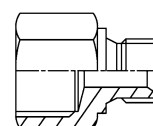

Type II

## Schotkoppeling BSP - Pijpnaam licht

bestelnr.	uitw. BSP	metrisch	pijpdia. [mm]
8295-04-08L	1/4	M14 x 1,5	8
8295-04-10L	1/4	M16 x 1,5	10
8295-06-10L	3/8	M16 x 1,5	10
8295-06-12L	3/8	M18 x 1,5	12
8295-08-08L	1/2	M14 x 1,5	8
8295-08-12L	1/2	M18 x 1,5	12
8295-08-15L	1/2	M22 x 1,5	15
8295-08-18L	1/2	M26 x 1,5	18
8295-12-18L	3/4	M26 x 1,5	18
8295-12-22L	3/4	M30 x 2	22



## Schotkoppeling BSP - Pijpnaam zwaar

bestelnr.	uitw. BSP	metrisch	pijpdia. [mm]
8296-04-08S	1/4	M16 x 1,5	8
8296-04-10S	1/4	M18 x 1,5	10
8296-06-10S	3/8	M18 x 1,5	10
8296-06-12S	3/8	M20 x 1,5	12
8296-08-08S	1/2	M16 x 1,5	8
8296-08-12S	1/2	M20 x 1,5	12
8296-08-16S	1/2	M24 x 1,5	16
8296-08-20S	1/2	M30 x 2,0	20
8296-12-20S	3/4	M30 x 2,0	20
8296-12-25S	3/4	M36 x 2,0	25



### Aansluiting voor hogedrukreinigers Metrisch/BSP

bestelnr.	moer metrisch	inw. BSP
2294-22-04	22 x 1,5	1/4-19
2294-22-06	22 x 1,5	3/8-19

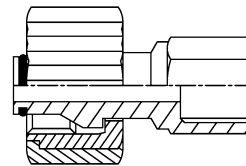

### Verbindingsnippel voor hogedrukreinigers Metrisch

bestelnr.	uitw. metrisch	uitw. metrisch
2299-22-22	22 x 1,5	22 x 1,5

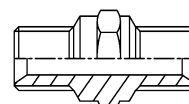

### Bochtstuk 45° S-serie Metrisch

bestelnr.	pijpopn. metrisch	wartel metrisch	pijpdia.
2896-24-08	24 x 1,5	24 x 1,5	16S
2896-30-10	30 x 2,0	30 x 2,0	20S
2896-36-12	36 x 2,0	36 x 2,0	25S
2896-42-16	42 x 2,0	42 x 2,0	30S
2896-52-20	52 x 2,0	52 x 2,0	38S

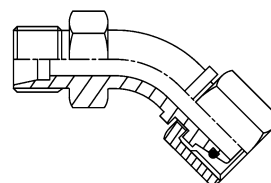

### Bochtstuk 90° S-serie Metrisch

bestelnr.	pijpopn. metrisch	wartel metrisch	pijpdia.
2996-24-08	24 x 1,5	24 x 1,5	16S
2996-30-10	30 x 2,0	30 x 2,0	20S
2996-36-12	36 x 2,0	36 x 2,0	25S
2996-42-16	42 x 2,0	42 x 2,0	30S
2996-52-20	52 x 2,0	52 x 2,0	38S

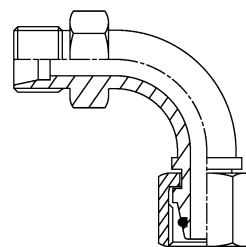

**Dubbelnippel Metrisch**

bestelnr.	uitw. metrisch	uitw. metrisch
2288-10-10	10 x 1	10 x 1
2288-12-10	12 x 1,5	10 x 1
2288-12-12	12 x 1,5	12 x 1,5
2288-14-12	14 x 1,5	12 x 1,5
2288-14-14	14 x 1,5	14 x 1,5
2288-16-12	16 x 1,5	12 x 1,5
2288-16-14	16 x 1,5	14 x 1,5
2288-16-16	16 x 1,5	16 x 1,5
2288-18-16	18 x 1,5	16 x 1,5
2288-18-18	18 x 1,5	18 x 1,5
2288-22-18	22 x 1,5	18 x 1,5
2288-22-22	22 x 1,5	22 x 1,5
2288-26-22	26 x 1,5	22 x 1,5
2288-26-26	26 x 1,5	26 x 1,5
2288-30-30	30 x 1,5	30 x 1,5
2288-30-38	30 x 1,5	38 x 1,5
2288-38-38	38 x 1,5	38 x 1,5

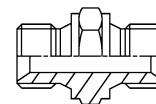
**Banjobout Enkel Metrisch**

bestelnr.	uitw. metrisch
2260-08-01	M08 x 1
2260-10-01	M10 x 1
2260-12-1.5	M12 x 1,5
2260-14-1.5	M14 x 1,5
2260-16-1.5	M16 x 1,5
2260-18-1.5	M18 x 1,5
2260-22-1.5	M22 x 1,5
2260-26-1.5	M26 x 1,5
2260-30-1.5	M30 x 1,5

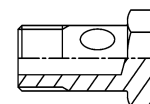
**Banjobout Dubbel Metrisch**

bestelnr.	uitw. metrisch
2261-08-01	M08 x 1
2261-10-01	M10 x 1
2261-12-1.5	M12 x 1,5
2261-14-1.5	M14 x 1,5
2261-16-1.5	M16 x 1,5
2261-18-1.5	M18 x 1,5

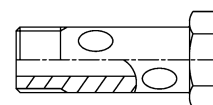
**Banjobout Enkel BSP**

bestelnr.	uitw. BSP
2262-02	1/8-28
2264-04	1/4-19
2262-06	3/8-19
2262-08	1/2-14

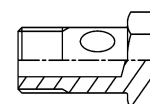

### Banjobout Enkel Metrisch - voor koppeling 10212

bestelnr.	uitw. metrisch
2263-12-1.5	M12 x 1,5
2263-26-1.5	M26 x 1,5

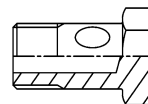

### Banjobout Enkel BSP - voor koppeling 10212

bestelnr.	uitw. BSP
2264-04	1/4-19
2264-06	3/8-19
2264-08	1/2-14
2264-10	5/8-14
2264-12	3/4-14

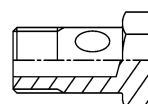

### Banjoverbinding Metrisch

bestelnr.	uitw. metrisch	oogdia. [mm]
2281-12-10	12 x 1,5	10
2281-14-12	14 x 1,5	12
2281-14-14	14 x 1,5	14
2281-16-14	16 x 1,5	14
2281-16-16	16 x 1,5	16
2281-18-16	18 x 1,5	16
2281-22-18	22 x 1,5	18
2281-22-22	22 x 1,5	22
2281-26-22	26 x 1,5	22
2281-30-26	30 x 1,5	26

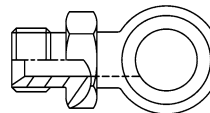

### ORFS Moer

bestelnr.	inw. ORFS	pijpdia. [mm]	pijpdia. [inch]
7140-04	9/16-18	6	1/4
7140-06	1 1/16-16	8	5/16
7140-06	1 1/16-16	10	3/8
7140-08	1 3/16-16	12	1/2
7140-10	1-14	14	
7140-10	1-14	15	
7140-10	1-14	16	5/8
7140-12	1 3/16-12	18	
7140-12	1 3/16-12	20	3/4
7140-16	1 7/16-12	22	
7140-16	1 7/16-12	25	1
7140-20	1 11/16-12	28	
7140-20	1 11/16-12	30	
7140-20	1 11/16-12	32	1 1/4
7140-24	2-12	35	
7140-24	2-12	38	1 1/2

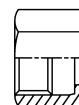

## ORFS Plug

bestelnr.	uitw. ORFS	pijpdia. [inch]	pijpdia. [mm]
7120-04	9/16-18	1/4	6
7120-06	11/16-16	3/8	8-10
7120-08	13/16-16	1/2	12
7120-10	1-14	5/8	14-16
7120-12	1 3/16-12	3/4	18-20
7120-16	1 7/16-12	1	22-25
7120-20	1 11/16-12	1 1/4	28-32
7120-24	2-12	1 1/2	35-38

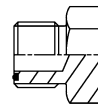

## ORFS Kap

bestelnr.	inw. ORFS	pijpdia. [inch]	pijpdia. [mm]
7115-04	9/16-18	1/4	6
7115-06	11/16-16	3/8	8-10
7115-08	13/16-16	1/2	12
7115-10	1-14	5/8	14-16
7115-12	1 3/16-12	3/4	18-20
7115-16	1 7/16-12	1	22-25
7115-20	1 11/16-12	1 1/4	28-32
7115-24	2-12	1 1/2	35-38

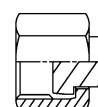

## ORFS Kniekoppeling

bestelnr.	uitw. ORFS	wartel ORFS	pijpdia. [inch]	pijpdia. [mm]
7622-04-04	9/16-18	9/16-18	1/4	6
7622-06-06	11/16-16	11/16-16	3/8	8-10
7622-08-08	13/16-16	13/16-16	1/2	12
7622-10-10	1-14	1-14	5/8	14-16
7622-12-12	1 3/16-12	1 3/16-12	3/4	18-20
7622-16-16	1 7/16-12	1 7/16-12	1	22-25
7622-20-20	1 11/16-12	1 11/16-12	1 1/4	28-32
7622-24-24	2-12	2-12	1 1/2	35-38

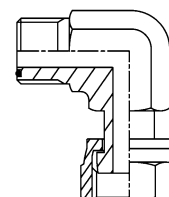

## ORFS/ORFS Dubbelnippel

bestelnr.	uitw. ORFS	pijpdia. [mm]	pijpdia. [inch]
7222-04-04	9/16-18	6	1/4
7222-06-06	11/16-16	8	5/16
7222-06-06	11/16-16	10	3/8
7222-08-08	13/16-16	12	1/2
7222-10-10	1-14	14-15-16	5/8
7222-12-12	1 3/16-12	18-20	3/4
7222-16-16	1 7/16-12	22-25	1
7222-20-20	1 11/16-12	28-30-32	1 1/4
7222-24-24	2-12	35-38	1 1/2

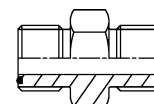

### Adapter 45° ORFS/ORFS

bestelnr.	uitw. ORFS	wartel ORFS	pijpdia. [mm]	pijpdia. [inch]
7422-04-04	9/16-18	9/16-18	6	1/4
7422-06-06	11/16-16	11/16-16	10	3/8
7422-08-08	13/16-16	13/16-16	12	1/2
7422-10-10	1-14	1-14	14-15-16	5/8
7422-12-12	1 3/16-12	1 3/16-12	18-20	3/4
7422-16-16	1 7/16-12	1 7/16-12	22-25	1
7422-20-20	1 11/16-12	1 11/16-12	28-30-32	1 1/4
7422-24-24	2-12	2-12	35-38	1 1/2

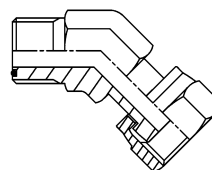

### Adapter 90° ORFS/ORFS

bestelnr.	uitw. ORFS	uitw. ORFS	pijpdia. [mm]	pijpdia. [inch]
7922-04-04	9/16-18	9/16-18	6	1/4
7922-06-06	11/16-16	11/16-16	10	3/8
7922-08-08	13/16-16	13/16-16	12	1/2
7922-10-10	1-14	1-14	14-15-16	5/8
7922-12-12	1 3/16-12	1 3/16-12	18-20	3/4
7922-16-16	1 7/16-12	1 7/16-12	22-25	1

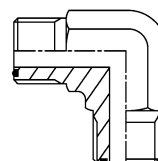

### ORFS T-koppeling

bestelnr.	uitw. ORFS	pijpdia. [inch]	pijpdia. [mm]
7722-04-04	9/16-18	1/4	6
7722-06-06	11/16-16	3/8	8-10
7722-08-08	13/16-16	1/2	12
7722-10-10	1-14	5/8	14-16
7722-12-12	1 3/16-12	3/4	18-20
7722-16-16	1 7/16-12	1	22-25
7722-20-20	1 11/16-12	1 1/4	28-32
7722-24-24	2-12	1 1/2	35-38

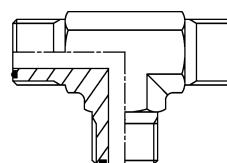

### Kruisstuk ORFS

bestelnr.	uitw. ORFS	pijpdia. [inch]	pijpdia. [mm]
7377-04-04	9/16-18	1/4	6
7377-06-06	11/16-16	3/8	8-10
7377-08-08	13/16-16	1/2	12
7377-10-10	1-14	5/8	14-16
7377-12-12	1 3/16-12	3/4	18-20
7377-16-16	1 7/16-12	1	22-25
7377-20-20	1 11/16-12	1 1/4	28-32
7377-24-24	2-12	1 1/2	35-38

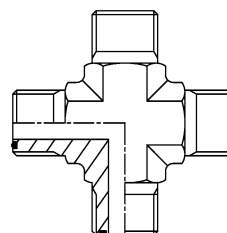

## Verloopadapter ORFS/ORFS

bestelnr.	inw. ORFS	uitw. ORFS
7274-08-04	13/16-16	9/16-18
7274-10-04	1-14	9/16-18
7274-10-08	1-14	1 3/16-16
7274-12-06	1 3/16-12	1 1/16-16
7274-12-08	1 3/16-12	1 3/16-16
7274-16-08	1 7/16-12	1 3/16-16
7274-16-10	1 7/16-12	1-14
7274-16-12	1 7/16-12	1 3/16-12
7274-20-12	1 11/16-12	1 3/16-12
7274-24-16	2-12	1 7/16-12
7274-24-20	2-12	1 11/16-12

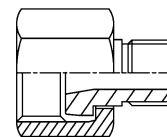

## T-stuk ORFS

bestelnr.	uitw. ORFS	wartel ORFS	pijpdia. [inch]	pijpdia. [mm]
7520-04-04	9/16-18	9/16-18	1/4	6
7520-06-06	11/16-16	11/16-16	3/8	8-10
7520-08-08	13/16-16	13/16-16	1/2	12
7520-10-10	1-14	1-14	5/8	14-16
7520-12-12	1 3/16-12	1 3/16-12	3/4	18-20
7520-16-16	1 7/16-12	1 7/16-12	1	22-25
7520-20-20	1 11/16-12	1 11/16-12	1 1/4	28-32
7520-24-24	2-12	2-12	1 1/2	35-38

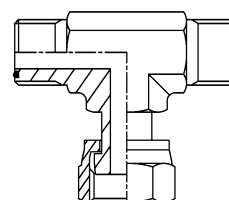

## ORFS/UNF Verbindingsnippel

bestelnr.	uitw. ORFS	uitw. UNF	pijpdia. [mm]	pijpdia. [inch]
7223-04-04	9/16-18	7/16-20	6	1/4
7223-04-06	9/16-18	9/16-18	6	1/4
7223-04-08	9/16-18	3/4-16	6	1/4
7223-06-06	11/16-16	9/16-18	8	5/16
7223-06-04	11/16-16	7/16-20	8	5/16
7223-06-08	11/16-16	3/4-16	8	5/16
7223-06-10	11/16-16	7/8-14	8	5/16
7223-06-06	11/16-16	9/16-18	10	3/8
7223-06-04	11/16-16	7/16-20	10	3/8
7223-06-08	11/16-16	3/4-16	10	3/8
7223-06-10	11/16-16	7/8-14	10	3/8
7223-08-08	13/16-16	3/4-16	12	1/2
7223-08-06	13/16-16	9/16-18	12	1/2
7223-08-10	13/16-16	7/8-14	12	1/2
7223-08-12	13/16-16	1 1/16-12	12	1/2
7223-08-16	13/16-16	1 5/16-12	12	1/2
7223-10-10	1-14	7/8-14	14-15-16	
7223-10-08	1-14	3/4-16	14-15-16	
7223-10-12	1-14	1 1/16-12	14-15-16	
7223-10-10	1-14	7/8-14	16	5/8
7223-12-12	1 3/16-12	1 1/16-12	18-20	
7223-12-08	1 3/16-12	3/4-16	18-20	
7223-12-10	1 3/16-12	7/8-14	18-20	
7223-12-16	1 3/16-12	1 5/16-12	18-20	
7223-16-16	1 7/16-12	1 5/16-12	22-25	
7223-16-12	1 7/16-12	1 1/16-12	22-25	
7223-16-20	1 7/16-12	1 5/8-12	22-25	
7223-20-20	1 11/16-12	1 5/8-12	28-30-32	
7223-20-16	1 11/16-12	1 5/16-12	28-30-32	
7223-20-24	1 11/16-12	1 7/8-12	28-30-32	
7223-24-24	2-12	1 7/8-12	35-38	
7223-24-20	2-12	1 5/8-12	35-38	

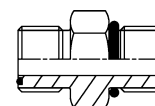



## Adapters

### Adapter ORFS/UNF

bestelnr.	wartel ORFS	uitw. UNF
7273-04-04	9/16-18	7/16-20
7273-06-06	1 1/16-16	9/16-18
7273-08-08	1 3/16-16	3/4-16
7273-10-10	1-14	7/8-14
7273-12-12	1 3/16-12	1 1/16-12
7273-16-16	1 7/16-12	1 5/16-12
7273-20-20	1 11/16-12	1 5/8-12
7273-24-24	1 7/8-12	1 7/8-12

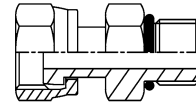

### Adapter 45° ORFS/UNF

bestelnr.	uitw. ORFS	uitw. UNF	pijpdia. [inch]	pijpdia. [mm]
7423-04-04	9/16-18	7/16-20	1/4	6
7423-06-06	11/16-16	9/16-18	5/16	8
7423-08-08	13/16-16	3/4-16	1/2	12
7423-12-12	1 3/16-12	1 1/16-12	3/4	18-20
7423-16-16	1 7/16-12	1 5/16-12	1	22-25
7423-20-20	1 11/16-12	1 5/8-12	1 1/4	28-30-32
7423-24-24	1 7/8-12	1 7/8-12	1 1/2	35-38

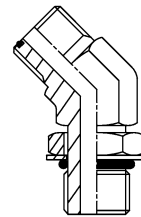

### Adapter 90° ORFS/UNF

bestelnr.	uitw. ORFS	uitw. UNF	pijpdia. [inch]	pijpdia. [mm]
7623-04-06	9/16-18	9/16-18	1/4	6
7623-06-06	11/16-16	9/16-18	5/16	8
7623-08-06	13/16-16	9/16-18	1/2	12
7623-08-08	13/16-16	3/4-16	1/2	12
7623-10-10	1-14	7/8-14	5/8	16
7623-12-12	1 3/16-12	1 1/16-12	3/4	18-20
7623-16-16	1 7/16-12	1 5/16-12	1	22-25
7623-20-20	1 11/16-12	1 5/8-12	1 1/4	28-30-32
7623-24-24	2-12	1 7/8-12	1 1/2	35-38

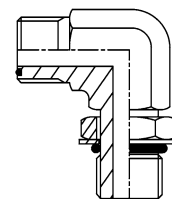

### T-stuk ORFS/UNF

bestelnr.	uitw. ORFS	uitw. UNF	pijpdia. [inch]	pijpdia. [mm]
7522-04-04	9/16-18	7/16-20	1/4	6
7522-06-06	11/16-16	9/16-18	5/16	8
7522-08-08	13/16-16	3/4-16	1/2	12
7522-10-10	1-14	7/8-14	5/8	16
7522-12-12	1 3/16-12	1 1/16-12	3/4	18-20
7522-16-16	1 7/16-12	1 5/16-12	1	22-25
7522-20-20	1 11/16-12	1 5/8-12	1 1/4	28-30-32

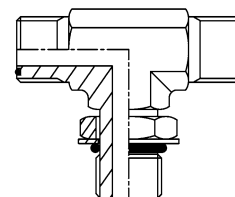

## T-stuk ORFS/UNF

bestelnr.	uitw. ORFS	uitw. UNF	pijpdia. [inch]	pijpdia. [mm]
7523-04-04	9/16-18	7/16-20	1/4	6
7523-06-06	11/16-16	9/16-18	5/16	8
7523-08-08	13/16-16	3/4-16	1/2	12
7523-10-10	1-14	7/8-14	5/8	16
7523-12-12	1 3/16-12	1 1/16-12	3/4	18-20
7523-16-16	1 7/16-12	1 5/16-12	1	22-25
7523-20-20	1 11/16-12	1 5/8-12	1 1/4	28-30-32
7523-24-24	2-12	1 7/8-12	1 1/2	35-38

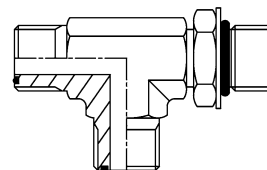

## ORFS/BSP Verbindingsnippel

bestelnr.	uitw. ORFS	uitw. BSP	pijpdia. [mm]	pijpdia. [inch]
7224-04-02	9/16-18	1/8	6	1/4
7224-04-04	9/16-18	1/4	6	1/4
7224-04-06	9/16-18	3/8	6	1/4
7224-04-08	9/16-18	1/2	6	1/4
7224-06-02	11/16-16	1/8	8	5/16
7224-06-04	11/16-16	1/4	8	5/16
7224-06-06	11/16-16	3/8	8	5/16
7224-06-08	11/16-16	1/2	8	5/16
7224-06-12	11/16-16	3/4	8	5/16
7224-06-02	11/16-16	1/8	10	3/8
7224-06-04	11/16-16	1/4	10	3/8
7224-06-06	11/16-16	3/8	10	3/8
7224-06-08	11/16-16	1/2	10	3/8
7224-06-12	11/16-16	3/4	10	3/8
7224-08-04	13/16-16	1/4	12	1/2
7224-08-06	13/16-16	3/8	12	1/2
7224-08-08	13/16-16	1/2	12	1/2
7224-08-12	13/16-16	3/4	12	1/2
7224-10-06	1-14	3/8	14-15-16	5/8
7224-10-08	1-14	1/2	14-15-16	5/8
7224-10-12	1-14	3/4	14-15-16	5/8
7224-10-16	1-14	1	14-15-16	5/8
7224-12-08	1 3/16-12	1/2	18-20	3/4
7224-12-12	1 3/16-12	3/4	18-20	3/4
7224-12-16	1 3/16-12	1	18-20	3/4
7224-12-20	1 3/16-12	1 1/4	18-20	3/4
7224-16-12	1 7/16-12	3/4	22-25	1
7224-16-16	1 7/16-12	1	22-25	1
7224-16-20	1 7/16-12	1 1/4	22-25	1
7224-16-24	1 7/16-12	1 1/2	22-25	1
7224-20-16	1 11/16-12	1	28-30-32	1 1/4
7224-20-20	1 11/16-12	1 1/4	28-30-32	1 1/4
7224-20-24	1 11/16-12	1 1/2	28-30-32	1 1/4

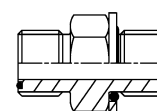

### ORFS/BSP Kniestuk 90°

bestelnr.	uitw. ORFS	uitw. BSP	pijpdia. [mm]	pijpdia. [inch]
7624-04-02	9/16-18	1/8	6	1/4
7624-04-04	9/16-18	1/4	6	1/4
7624-04-06	9/16-18	3/8	6	1/4
7624-06-04	11/16-16	1/4	8	5/16
7624-06-06	11/16-16	3/8	8	5/16
7624-06-08	11/16-16	1/2	8	5/16
7624-06-04	11/16-16	1/4	10	3/8
7624-06-06	11/16-16	3/8	10	3/8
7624-06-08	11/16-16	1/2	10	3/8
7624-08-04	13/16-16	1/4	12	1/2
7624-08-06	13/16-16	3/8	12	1/2
7624-08-08	13/16-16	1/2	12	1/2
7624-08-12	13/16-16	3/4	12	1/2
7624-10-06	1-14	3/8	14-15-16	5/8
7624-10-08	1-14	1/2	14-15-16	5/8
7624-10-12	1-14	3/4	14-15-16	5/8
7624-10-16	1-14	1	14-15-16	5/8
7624-12-08	1 3/16-12	1/2	18-20	3/4
7624-12-12	1 3/16-12	3/4	18-20	3/4
7624-12-16	1 3/16-12	1	18-20	3/4
7624-16-12	1 7/16-12	3/4	22-25	1
7624-16-16	1 7/16-12	1	22-25	1
7624-16-20	1 7/16-12	1 1/4	22-25	1
7624-20-16	1 11/16-12	1	28-30-32	1 1/4
7624-20-20	1 11/16-12	1 1/4	28-30-32	1 1/4
7624-20-24	1 11/16-12	1 1/2	28-30-32	1 1/4

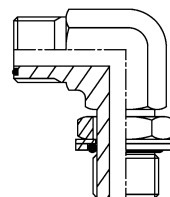

### Adapter ORFS/BSP

bestelnr.	wartel ORFS	uitw. BSP
7241-04-04	9/16-18	1/4-19
7241-06-04	11/16-16	1/4-19
7241-06-06	11/16-16	3/8-19
7241-08-06	13/16-16	3/8-19
7241-08-08	13/16-16	1/2-14
7241-10-08	1-14	1/2-14
7241-12-12	1 3/16-12	3/4-14
7241-16-16	1 7/16-12	1-11
7241-20-16	1 11/16-12	1-11
7241-20-20	1 11/16-12	1 1/4-11

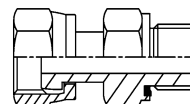

### Adapter 45° ORFS/BSP

bestelnr.	uitw. ORFS	uitw. BSP	pijpdia. [inch]	pijpdia. [mm]
7424-04-04	9/16-18	1/4-19	1/4	6
7424-06-06	11/16-16	3/8-19	5/16	8-10
7424-08-08	13/16-16	1/2-14	1/2	12
7424-10-08	1-14	1/2-14	5/8	14-15-16
7424-10-10	1-14	5/8-14	5/8	14-15-16
7424-10-12	1-14	3/4-14	5/8	14-15-16
7424-12-12	1 3/16-12	3/4-14	3/4	18-20
7424-16-16	1 7/16-12	1-11	1	22-25
7424-20-20	1 11/16-12	1 1/4-11	1 1/4	28-30-32
7424-24-24	2-12	1 1/2-11	1 1/2	35-38

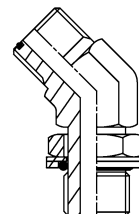

## T-stuk ORFS/BSP

bestelnr.	uitw. ORFS	uitw. BSP	pijpdia. [inch]	pijpdia. [mm]
7524-04-02	9/16-18	1/8-28		
7524-04-04	9/16-18	1/4-19	1/4	6
7524-06-04	11/16-16	1/4-19	5/16	8
7524-06-06	11/16-16	3/8-19	5/16	8-10
7524-08-06	13/16-16	3/8-19	1/2	12
7524-08-08	13/16-16	1/2-14	5/8	14-15-16
7524-10-08	1-14	1/2-14	5/8	14-15-16
7524-10-12	1-14	3/4-14	5/8	14-15-16
7524-12-12	1 3/16-12	3/4-14	3/4	18-20
7524-16-16	1 7/16-12	1-11	1	22-25
7524-20-20	1 11/16-12	1 1/4-11	1 1/4	28-30-32
7524-24-24	2-12	1 1/2-11	1 1/2	35-38

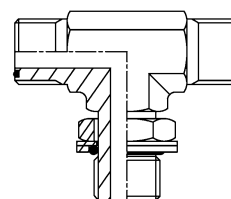

## ORFS Schotkoppeling

bestelnr.	uitw. ORFS	pijpdia. [inch]	pijpdia. [mm]
7248-04-04	9/16-18	1/4	6
7248-06-06	11/16-16	3/8	8-10
7248-08-08	13/16-16	1/2	12
7248-10-10	1-14	5/8	14-16
7248-12-12	1 3/16-12	3/4	18-20
7248-16-16	1 7/16-12	1	22-25
7248-20-20	1 11/16-12	1 1/4	28-32
7248-24-24	2-12	1 1/2	35-38

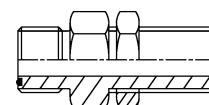

## Schotkoppeling 90° ORFS/ORFS

bestelnr.	uitw. ORFS	uitw. ORFS	pijpdia. [inch]	pijpdia. [mm]
7648-04-04	9/16-18	9/16-18	1/4	6
7648-06-06	11/16-16	11/16-16	3/8	8-10
7648-08-08	13/16-16	13/16-16	1/2	12
7648-10-10	1-14	1-14	5/8	14-16
7648-12-12	1 3/16-12	1 3/16-12	3/4	18-20
7648-16-16	1 7/16-12	1 7/16-12	1	22-25
7648-20-20	1 11/16-12	1 11/16-12	1 1/4	28-32
7648-24-24	2-12	2-12	1 1/2	35-38

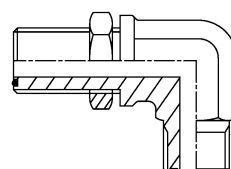

## ORFS / JIC Verloopkoppeling

bestelnr.	wartel ORFS	uitw. JIC	pijpdia. [inch]	pijpdia. [mm]
72225-04-04	9/16-18	7/16-20	1/4	6
72225-06-06	11/16-16	9/16-18	3/8	8-10
72225-08-08	13/16-16	3/4-16	1/2	12
72225-10-10	1-14	7/8-14	5/8	14-16
72225-12-12	1 3/16-12	1 1/16-12	3/4	18-20
72225-16-16	1 7/16-12	1 5/16-12	1	22-25
72225-20-20	1 11/16-12	1 5/8-12	1 1/4	28-32
72225-24-24	2-12	1 7/8-12	1 1/2	35-38

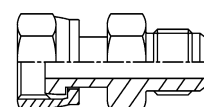

## Adapters

### Adapter ORFS/JIC

bestelnr.	uitw. ORFS	uitw. JIC
7227-04-04	9/16-18	7/16-20
7227-06-06	11/16-16	9/16-18
7227-08-08	13/16-16	3/4-16
7227-10-10	1-14	7/8-14
7227-12-12	1 3/16-12	1 1/16-12
7227-16-16	1 7/16-12	1 5/16-12

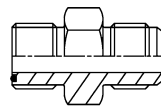

### ORFS T-koppeling

bestelnr.	uitw. ORFS	wartel ORFS	pijpdia. [inch]	pijpdia. [mm]
75925-04-04	9/16-18	9/16-18	1/4	6
75925-06-06	11/16-16	11/16-16	3/8	8-10
75925-08-08	13/16-16	13/16-16	1/2	12
75925-10-10	1-14	1-14	5/8	14-16
75925-12-12	1 3/16-12	1 3/16-12	3/4	18-20
75925-16-16	1 7/16-12	1 7/16-12	1	22-25
75925-20-20	1 11/16-12	1 11/16-12	1 1/4	28-32
75925-24-24	2-12	2-12	1 1/2	35-38

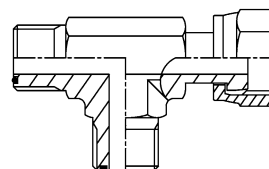

### Adapter NPT/ORFS

bestelnr.	uitw. NPT	uitw. ORFS	pijpdia. [inch]	pijpdia. [mm]
7225-04-06	1/4-18	11/16-16	1/4	6
7225-06-06	3/8-18	11/16-16	5/16	8
7225-08-06	1/2-14	11/16-16	1/2	12
7225-08-08	1/2-14	13/16-16	1/2	12
7225-08-10	1/2-14	1-14		
7225-12-10	3/4-14	1-14		
7225-12-12	3/4-14	1 3/16-12	3/4	18-20
7225-12-16	3/4-14	1 7/16-12	3/4	18-20
7225-16-12	1-11,5	1 3/16-12	1	22-25
7225-16-16	1-11,5	1 7/16-12	1	22-25

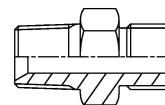

### Adapter 90° NPT/ORFS

bestelnr.	uitw. NPT	uitw. ORFS	pijpdia. [inch]	pijpdia. [mm]
7625-04-04	1/4-18	9/16-18	1/4	6
7625-06-06	3/8-18	11/16-16	5/16	8
7625-08-08	1/2-14	13/16-16	1/2	12
7625-08-10	1/2-14	1-14		
7625-12-12	3/4-14	1 3/16-12	3/4	18-20
7625-16-12	1-11,5	1 3/16-12	1	22-25
7625-16-16	1-11,5	1 7/16-12	1	22-25

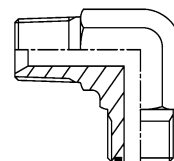

### Adapter ORFS/Metrisch

bestelnr.	uitw. ORFS	uitw. metrisch	pijpdia. [inch]	pijpdia. [mm]
7226-04-12	9/16-18	M12 x 1,5		
7226-04-14	9/16-18	M14 x 1,5		
7226-06-16	11/16-16	M16 x 1,5		
7226-08-18	13/16-16	M18 x 1,5		
7226-10-22	1-14	M22 x 1,5		
7226-12-27	1 3/16-12	M27 x 2		
7226-16-33	1 7/16-12	M33 x 2		
7226-20-42	1 11/16-12	M42 x 2		

